

OEM MODEL Section 3 Page #'s

CENTRIFUGES

BAXTER

Biofuge 17 & 17R	200
Cryofuge 6000	200
Haemofuge	200
Labofuge "A"	200
Medifuge	200
Megafuge	200
Omnifuge	200
Varifuge RF	200

BECKMAN

Microfuge "B"	303
Microfuge 11	303
Microfuge 12	303
Microfuge 152	303
TJ-6	303

BECKMAN/IRIS - STATSPIN® SERIES

CoagSpin (M940-22)	300-301
CritSpin (M960-12)	300-301
CritSpin (M961-22)	300-301
CytoFuge 2 (M801-22)	300-302
CytoVet (V801-22)	300-301
DiffSpin (M701-22)	300-301
Express 2 (M501-22)	300-302
MicroPrep (G600-22)	300-301
MP (M900-22)	300-301
MP (M901-22)	300-302
RP (M920-22)	300-301
VET Express (V501-22)	300-302
VT (V901-22)	300-302

BIO-DYNAMICS

#630 Select-A-Fuge	400-401
Universal #24	400-401
Uni-Meter #300	400-401

CLAY ADAMS

#0901 Tube Shields	513
#0908 Tube Shields	513
Analytical	512
Autocrit	500-501
Autocrit II	502
Autocrit Ultra III	503-504
Compact II	512
Cyclomixer	512
Dynac & Dynac II	504-506
Micro-Hematocrit	500-501
Micro-Hematocrit II	502
Micro-Hematocrit III	503-504
Physicians Compact & Physicians Jr.	512
QBC 4207	506

OEM MODEL Section 3 Page #'s

CENTRIFUGES *(continued)*

CLAY ADAMS *(continued)*

Readacrit & Readacrit MP	507-508
Safeguard	508
Safety-Head	508
Sero-Fuge & Sero-Fuge II	509-510
Triac	511
Yankee Pipette Shaker	512
Yankee Rotator	512

DRUCKER

L-708	600
L-711	600

EPPENDORF

3200	700
5402	700
5412	700
5413	700
5414	700
5415	700
5415C	700

HAMILTON BELL

VanGuard V-6000	800
VanGuard V-6500	800

IDEXX - STATSPIN® SERIES

VT (V901-22)	300-302
--------------	---------

IEC (International Equipment Co.)

B20-A (Late Model)	902
Centra-7	902
Centra-7R	902
CH	902
CL	902
CM	902
CRU5000	902
CS	902
CU5000	902
DPR6000	902
H	902
HN	902
HNS	902
HNS II	902
HT	902
K Size 2	902
MB Micro-Hematocrit	900-901
PR-6	902
PR-6000	902
PR-J	902
Spinette	901
UV	902

(continued)

Centrifuges & Other Lab Equipment

OEM MODEL Section 5 Page #'s

CENTRIFUGES *(continued)*

SORVALL

GLC-1	1000
GLC-2	1000
GLC-2B	1000
GLC-3	1000
GLC-4	1000
Motors Marked "Howard"	1000
RC-2B	1000
RC-3	1000
RC-3B	1000
RC-3C	1000
RC-5	1000
RC-5B	1000
RC-5C	1000
RT-6000	1000

NUTATORS & ROTATORS

CLAY ADAMS

421105 Nutator	1100
421106 Nutator	1100

LABNET INTERNATIONAL, INC.

H5500 Mini LabRoller™	1100
S0500 GyroMini™	1100
S0600 Enduro™ MiniMix™	1100

RPI Part #BAB001
OEM Part #002790/004936

BRUSH

- 2 per package
- Size: .252" x .390" x .866" lg.
- Radius: .937"
- No spring
- 1.610" copper shunt wire with 1/4" female push-on connector

Fits: Brush Holder Assembly
Model: Megafuge

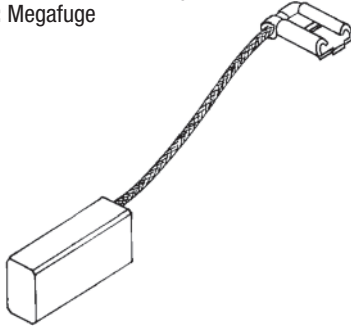

RPI Part #BAB004
OEM Part #001786

BRUSH

- 2 per package
- Size: .196" x .236" x .568" lg.
- Radius: .50"
- Spring length: 1.03"
- .925" copper shunt wire

Fits: Brush Holder Assembly
Model: Haemofuge

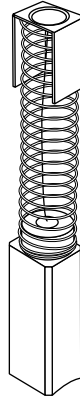

RPI Part #BAB006
OEM Part #003854

BRUSH

- 2 per package
- Size: .252" x .392" x .875" lg.
- Radius: .94"
- No spring
- 1.69" copper shunt wire with 1/4" female push-on connector and sensor wires

Fits: Brush Holder Assembly
Model: Omnifuge

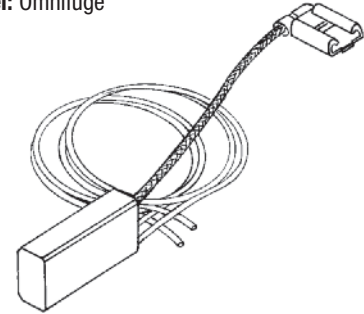

RPI Part #BAB005
OEM Part #002779

BRUSH

- 2 per package
- Size: .252" x .390" x .866" lg.
- Radius: .94"
- No spring
- 1.88" copper shunt wire with 1/4" female push-on connector

Fits: Brush Holder Assembly
Models: Biofuge 17 & Biofuge 17R

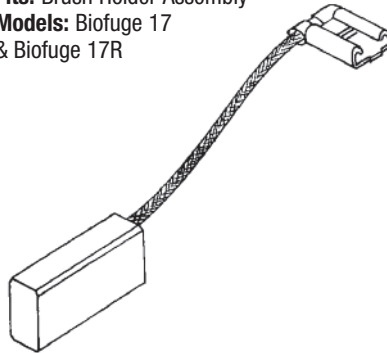

RPI Part #BAB002
OEM Part #001193

BRUSH

- 2 per package
- Size: .196" x .236" x .469" lg.
- Radius: .56"
- Spring length: 1.19"
- No shunt wire

Fits: Brush Holder Assembly
Model: Medifuge

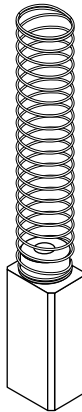

RPI Part #BAB007
OEM Part #001811

BRUSH

- 2 per package
- Size: .252" x .394" x .88" lg.
- Radius: .75"
- 1.94" copper shunt wire

Fits: Brush Holder Assembly
Model: Varifuge RF

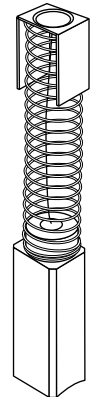

RPI Part #BAB003
OEM Part #001754

BRUSH

- 2 per package
- Size: .252" x .315" x .898" lg.
- Radius: .56"
- Spring length: 1.88"
- No shunt wire

Fits: Brush Holder Assembly
Model: Labofuge "A"

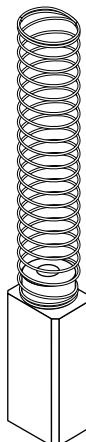

RPI Part #BAB008
OEM Part #006914

BRUSH

- 2 per package
- Size: .315" x .787" x .860" lg.
- No spring
- 3.88" copper shunt wire with red top pad and sensor wire

Fits: Brush Holder Assembly
Model: Cryofuge 6000

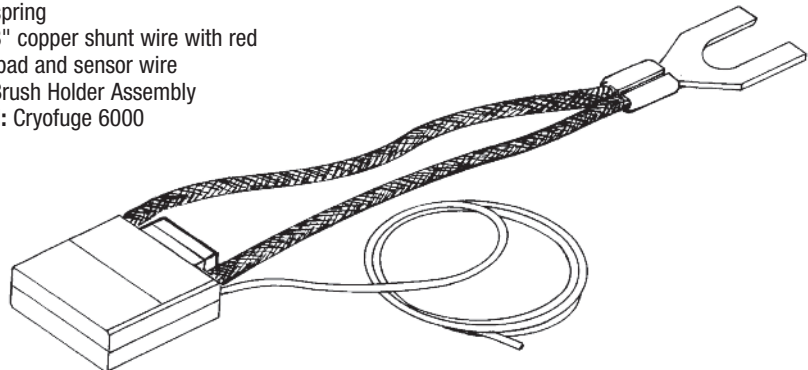

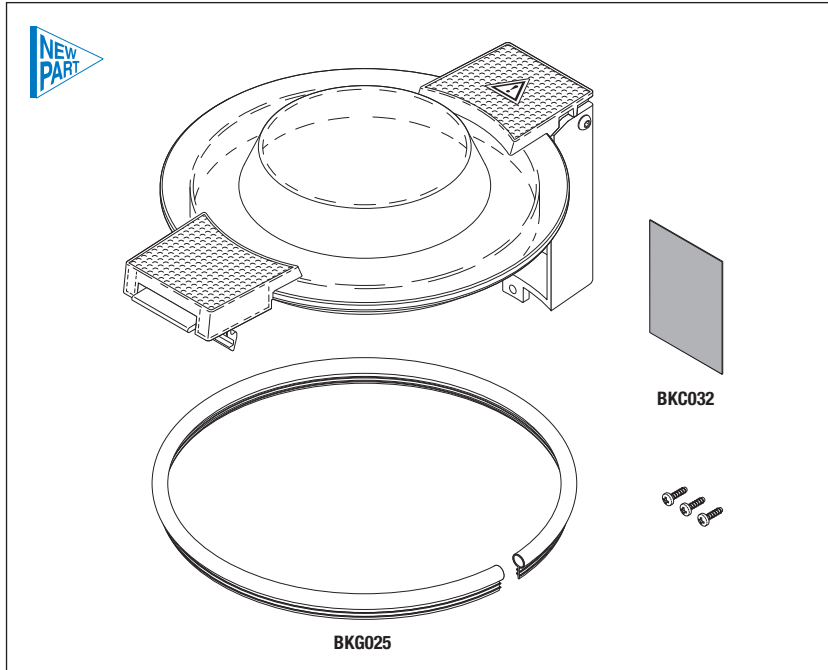

RPI Part #BKK019
OEM Part #X01-003494-001/X01-002528-00

TOP COVER ASSEMBLY

- Includes all parts as shown

Models:

BECKMAN/IRIS: CoagSpin (M940-22), CritSpin (M960-12), CritSpin (M961-22), CytoFuge 2 (M801-22), CytoVet (V801-22), DiffSpin (M701-22), Express 2 (M501-22), MicroPrep (G600-22), MP (M900-22), MP (M901-22), RP (M920-22), VT (V901-22) & VET Express (V501-22); and **IDEXX:** VT (V901-22)

RPI Part #BKC032
OEM Part # (No OEM Part # Available)



HINGE COVER

- Size: 1.64" x 2.20"; Color: Black
- Adhesive backing
- Included in: Top Cover Assembly (RPI Part #BKK019)

Fits: Hinge Housing

Models:

BECKMAN/IRIS: CoagSpin (M940-22), CritSpin (M960-12), CritSpin (M961-22), CytoFuge 2 (M801-22), CytoVet (V801-22), DiffSpin (M701-22), Express 2 (M501-22), MicroPrep (G600-22), MP (M900-22), MP (M901-22), RP (M920-22), VT (V901-22) & VET Express (V501-22); and **IDEXX:** VT (V901-22)

RPI Part #BKG025
OEM Part #X01-004635-001



BULB GASKET

- Length: 19.75"
- Included in: Top Cover Assembly (RPI Part #BKK019)

Models:

BECKMAN/IRIS: CoagSpin (M940-22), CritSpin (M960-12), CritSpin (M961-22), CytoFuge 2 (M801-22), CytoVet (V801-22), DiffSpin (M701-22), Express 2 (M501-22), MicroPrep (G600-22), MP (M900-22), MP (M901-22), RP (M920-22), VT (V901-22) & VET Express (V501-22); and **IDEXX:** VT (V901-22)

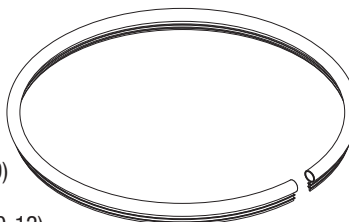

BKG025
 CROSS SECTION
 SHOWN ACTUAL SIZE

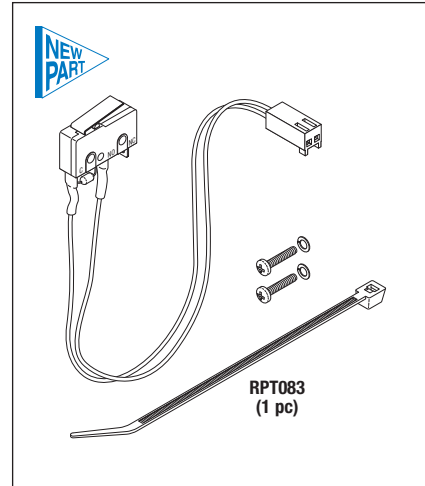

RPI Part #BKA026
OEM Part #X01-003495-001

SAFETY SWITCH ASSEMBLY

- 5A@250VAC; SPST
- Includes all parts as shown

Models:

BECKMAN/IRIS: CoagSpin (M940-22), CritSpin (M960-12), CritSpin (M961-22), CytoFuge 2 (M801-22), CytoVet (V801-22), DiffSpin (M701-22), Express 2 (M501-22), MicroPrep (G600-22), MP (M900-22), MP (M901-22), RP (M920-22), VT (V901-22) & VET Express (V501-22); and **IDEXX:** VT (V901-22)

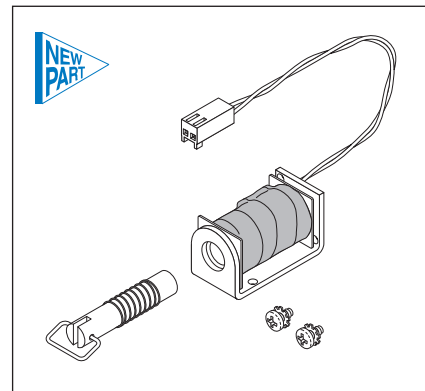

RPI Part #BKS027
OEM Part #X01-004076-001

SOLENOID

- Pull style 6 VDC
- Includes all parts as shown

Models:

BECKMAN/IRIS: CoagSpin (M940-22), CritSpin (M960-12), CritSpin (M961-22), CytoFuge 2 (M801-22), CytoVet (V801-22), DiffSpin (M701-22), Express 2 (M501-22), MicroPrep (G600-22), MP (M900-22), MP (M901-22), RP (M920-22), VT (V901-22) & VET Express (V501-22); and **IDEXX:** VT (V901-22)

Centrifuges

Models: StatSpin® Series

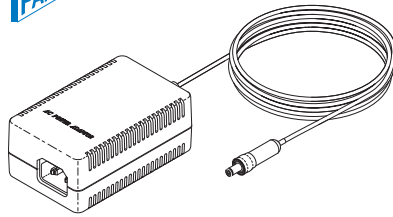

RPI Part #BKP034
OEM Part #X01-003553-001

POWER SUPPLY (SWITCHING)

- Input: 100-240VAC, 1.5A, 50-60 Hz.
- Output: 24 VDC, 2.5A
- Input Connector: EN60320-C13
- Output Connector: 5.5 mm (.218") OD Power Plug (for 2.1 mm (.064") Pin)
- Also available: Power Cord (RPI Part #RPC895)

Models:

BECKMAN/IRIS: CoagSpin (M940-22), CritSpin (M960-12), CritSpin (M961-22), CytoFuge 2 (M801-22), CytoVet (V801-22), DiffSpin (M701-22), Express 2 (M501-22), MicroPrep (G600-22), MP (M900-22), MP (M901-22), RP (M920-22), VT (V901-22) & VET Express (V501-22); and
IDEXX: VT (V901-22)

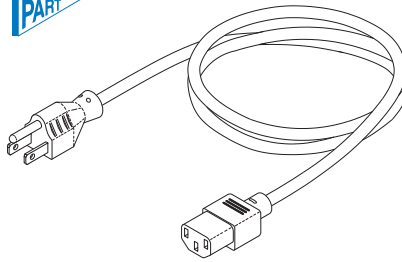

RPI Part #RPC895
OEM Part #X01-002532-001

POWER CORD

- Length: 8 ft.; Color: Black
- 18/3 SJT, 60°C; 10A@125VAC
- Plug: NEMA 5-15P
- Connector: EN60320-C13
- Also available: Power Supply (Switching) (RPI Part #BKP034)

Fits: Power Supply

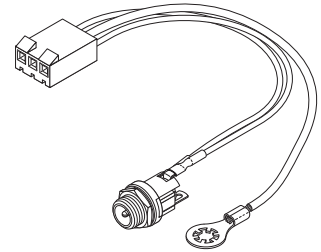

RPI Part #BKH035
OEM Part #X01-002529-001/X01-003493-001

POWER HARNESS

- Size: 6.25" lg.
- Includes: Mounting hardware

Models:

BECKMAN/IRIS: CoagSpin (M940-22), CritSpin (M960-12), CritSpin (M961-22), CytoFuge 2 (M801-22), CytoVet (V801-22), DiffSpin (M701-22), Express 2 (M501-22), MicroPrep (G600-22), MP (M900-22), MP (M901-22), RP (M920-22), VT (V901-22) & VET Express (V501-22); and
IDEXX: VT (V901-22)

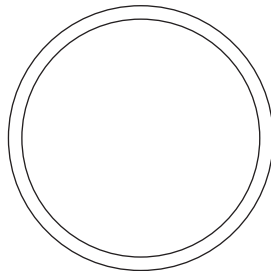

Shown Actual Size



RPI Part #BK0037
OEM Part #X01-005532-001

O-RING (ROTOR HOLDER)

- 3 per package
- Material: Nitrile (Buna N), 70 Duro
- Size: 1.239" ID x 1.379" OD x .070" C/S

Fits: Rotor Holder

Models:

BECKMAN/IRIS: CoagSpin (M940-22), CritSpin (M960-12), CritSpin (M961-22), CytoFuge 2 (M801-22), CytoVet (V801-22), DiffSpin (M701-22), Express 2 (M501-22), MicroPrep (G600-22), MP (M900-22), MP (M901-22), RP (M920-22), VT (V901-22) & VET Express (V501-22); and
IDEXX: VT (V901-22)

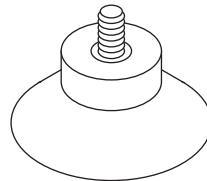

RPI Part #RPF894
OEM Part #X01-004288-001

SUCTION FEET

- 4 per package
- Material: Black isoprene
- Size: 1.00" dia. x .44" lg. with #8-32 x .25" lg. stud

Models:

BECKMAN/IRIS: DiffSpin (M701-22), Express 2 (M501-22), MP (M901-22), VT (V901-22) & VET Express (V501-22); and
IDEXX: VT (V901-22)



RPI Part #RPB896
OEM Part #X01-002542-001

BUMPER / FOOT

- 4 per package
- Material: Black non-marking polyurethane
- Size: .44" dia. x .20" h
- Adhesive backing
- Included in: Latch Kit (RPI Part #BKK020), Latch Kit (RPI Part #BKK021), Latch Kit (RPI Part #BKK022), and Latch Kit (RPI Part #BKK023)

Models:

BECKMAN/IRIS: CoagSpin (M940-22), CritSpin (M960-12), CritSpin (M961-22), CytoFuge 2 (M801-22), CytoVet (V801-22), MicroPrep (G600-22), MP (M900-22) & MP (M901-22); and
IDEXX: VT (V901-22)

RPI Part #BKK020
OEM Part #

(No OEM Part # Available)

LATCH KIT

- Includes all parts as shown

Models:

BECKMAN/IRIS: VT (V901-22); and
IDEXX: VT (V901-22)

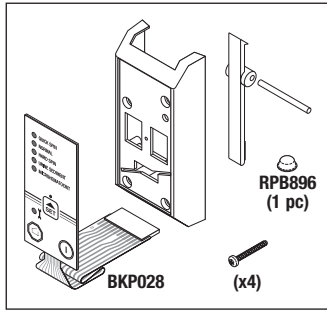

RPI Part #BKK022
OEM Part #

(No OEM Part # Available)

LATCH KIT

- Includes all parts as shown

Model:

BECKMAN/IRIS: CritSpin (M961-22)

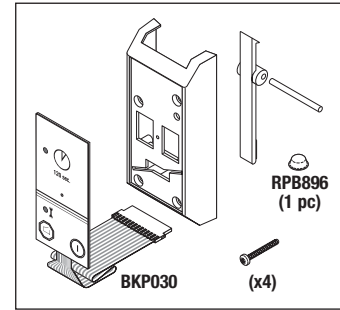

RPI Part #BKP028
OEM Part #X01-003943-001

MEMBRANE PANEL

- Size: 1.65" W x 3.47" L

- Adhesive backing

Fits: Latch Housing

Models:

BECKMAN/IRIS: VT (V901-22); and
IDEXX: VT (V901-22)

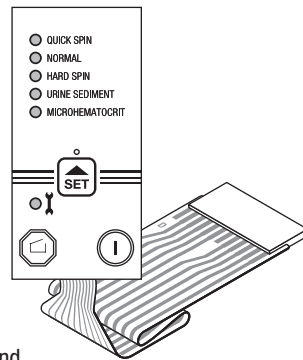

RPI Part #BKP030
OEM Part #X01-005203-001

MEMBRANE PANEL

- Size: 1.65" W x 3.47" L

- Adhesive backing

Fits: Latch Housing

Model:

BECKMAN/IRIS: CritSpin (M961-22)

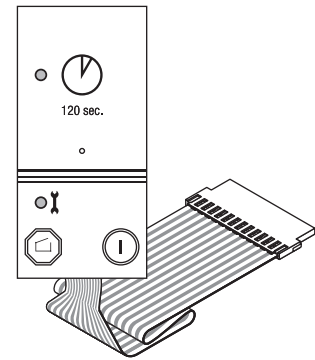

RPI Part #BKK021
OEM Part #

(No OEM Part # Available)

LATCH KIT

- Includes all parts as shown

Model:

BECKMAN/IRIS: MP (M901-22)

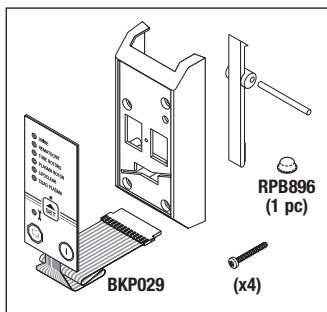

RPI Part #BKK023
OEM Part #

(No OEM Part # Available)

LATCH KIT

- Includes all parts as shown

Models:

BECKMAN/IRIS: Express 2 (M501-22)
& Vet Express (V501-22)

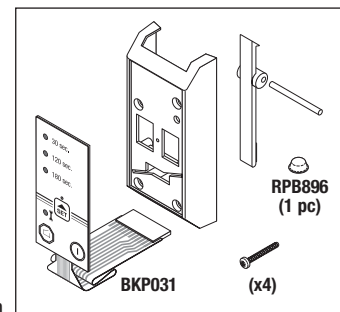

RPI Part #BKP029
OEM Part #X01-005171-001

MEMBRANE PANEL

- Size: 1.65" W x 3.47" L

- Adhesive backing

Fits: Latch Housing

Model:

BECKMAN/IRIS: MP (M901-22)

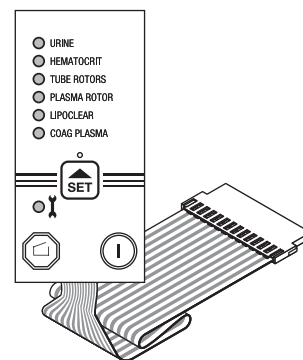

RPI Part #BKP031
OEM Part #X01-003944-001

MEMBRANE PANEL

- Size: 1.65" W x 3.47" L

- Adhesive backing

Fits: Latch Housing

Models:

BECKMAN/IRIS: Express 2 (M501-22)
& Vet Express (V501-22)

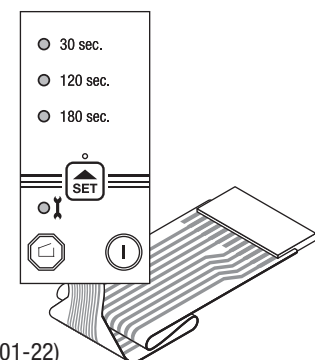

Centrifuges

Models: Microfuge "B", Microfuge 11, Microfuge 12, Microfuge 152 & TJ-6

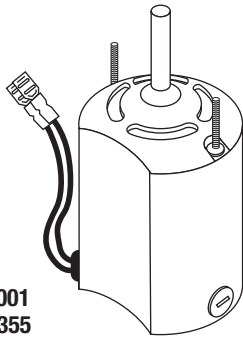

RPI Part #BKM001
OEM Part #314355

UNIVERSAL MOTOR

- 110 VAC, 50/60 Hz.
 - Maximum operating speed: 11,900 RPM
 - Sustaining current: 1A or less
- Model:** Microfuge 152



RPI Part #RPC036
OEM Part # (No OEM Part # Available)

BRUSH CAP

- 6 per package
 - 1/2-27 thread
- Fits:** Motor (RPI Part #BKM001)
Model: Microfuge 152

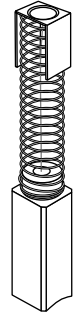

RPI Part #BKB005
OEM Part # (No OEM Part # Available)

BRUSH

- 2 per package
 - Size: .250" x .250" x .750" lg.
 - Radius: 1.00"
 - .75" lg. copper braided shunt wire
- Fits:** Brush Holder Assembly
Model: Microfuge 152

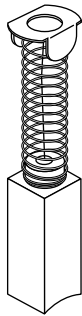

RPI Part #BKB003
OEM Part #340536

BRUSH

- 2 per package
 - Size: .250" x .375" x .797" lg.
 - Radius: .72"
 - 1.17" lg. copper braided shunt wire
- Fits:** Brush Holder Assembly
Model: TJ-6

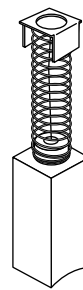

RPI Part #BKB004
OEM Part #343662

BRUSH

- 2 per package
 - Size: .250" x .375" x .875" lg.
 - Radius: 1.00"
 - 1.38" lg. copper braided shunt wire
- Fits:** Brush Holder Assembly
Model: Microfuge 11 & Microfuge 12

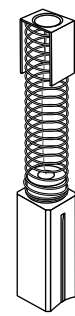

RPI Part #BKB006
OEM Part #343156

BRUSH

- 2 per package
 - Size: .250" x .250" x .500" lg.
 - Radius: .44"
 - .75" lg. copper braided shunt wire
- Fits:** Brush Holder Assembly
Model: Microfuge "B"

**For quality replacement parts, you can depend on RPI.
Your 100% satisfaction is guaranteed!**

NOTES: _____

RPI Part #BDA008
OEM Part #1-30015

SHAFT ADAPTOR
Fits: Motor Shaft
Model: #630
Select-A-Fuge

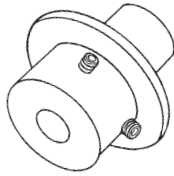

RPI Part #BDA015
OEM Part #1-61716

HEAD COVER ASSEMBLY
Fits: Motor Shaft
Model: #630
Select-A-Fuge

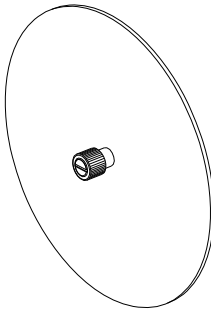

RPI Part #BDB001
OEM Part #919808

BRUSH
• 2 per package
• Size: 1/4 x .190 x 21/32
• Spring Length: 1-1/8"
• Copper shunt wire
Fits: Brush Holder Assembly
Models: Universal #24
& #630 Select-A-Fuge
(Serial #71000 and above)



RPI Part #BDB002
OEM Part #919807

BRUSH
• 2 per package
• Size: 1/4 x 1/8 x 21/32
• Spring Length: 1-3/8"
Fits: Brush Holder Assembly
Models: #630 Select-A-Fuge
(Serial #70999 and below)

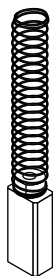

RPI Part #BDC006
OEM Part #1-61705

SPEED CONTROL
• Mounts in control panel
Model: #630
Select-A-Fuge

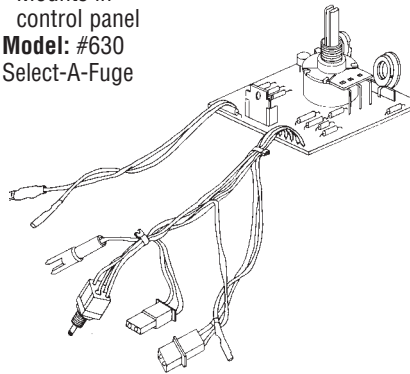

RPI Part #BDF009
OEM Part #1-06307

FOOT
• 4 per package
• Suction cup style
8-32 x 3/8 stud
Model: #630 Select-A-Fuge

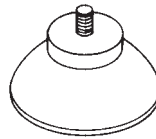

RPI Part #BDG003
OEM Part #61706

LID GASKET
Fits: Housing Assembly
Model: #630 Select-A-Fuge

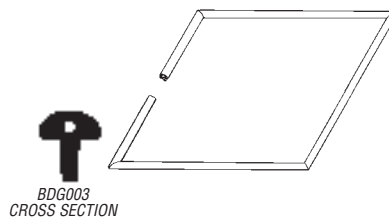

RPI Part #BDG004
OEM Part #106332

HEMATOCRIT GASKET
Fits: Head Assembly
Model: #630
Select-A-Fuge



RPI Part #BDL011
OEM Part #1-06345

BRAKE LOCK LINING
• 12 per package
Fits: Brake Assembly
Model: #630 Select-A-Fuge

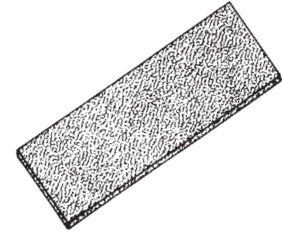

RPI Part #BDM007
OEM Part #1-61703

MOTOR ASSEMBLY
• 115VAC, 60 Hz., 1/10 HP, 10,000 RPM
• Includes motor, and
(2) wiring connector
Model: #630
Select-A-Fuge

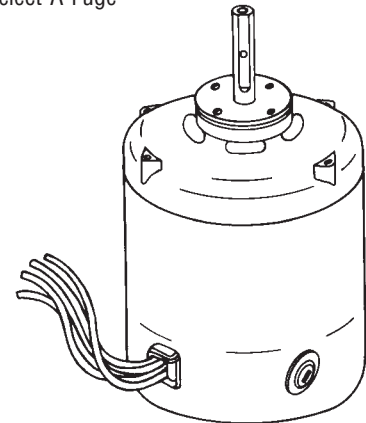

RPI Part #BDN013
OEM Part #1-06304

HEAD COVER NUT
Fits: Head Assembly
Model: #630
Select-A-Fuge

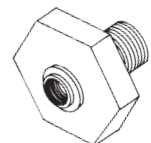

**Orders placed before
2:00 P.M.
(Pacific Time)
will be shipped the
same day.**

MOTORS & BRUSHES TO FIT CLAY ADAMS CENTRIFUGES

MODEL	MOTOR REPLACEMENT	RPI MOTOR BRUSH & CAP REPLACEMENT		OEM MOTOR BRUSH & CAP REPLACEMENT	
		Brush	Cap	Brush	Cap
Autocrit	CAM115	CAB018	RPC036	CAB018	RPC036
Autocrit II	CAM115	CAB018	RPC036	CAB018	RPC036
Autocrit Ultra III	CAM115	CAB018	RPC036	CAB018	RPC036
Compact II	CAM102				
Dynac	CAM026	CAB018	RPC036*	CAB019	
Dynac II		CAB018			
Micro-Hematocrit	CAM115	CAB018	RPC036	CAB018	RPC036
Micro-Hematocrit II	CAM115	CAB018	RPC036	CAB018	RPC036
Micro-Hematocrit III	CAM115	CAB018	RPC036	CAB018	RPC036
Readacrit	CAM024	CAB022	RPC039	CAB022	RPC039
Readacrit MP	CAM024	CAB022	RPC039	CAB022	RPC039
Safeguard		CAB018			
Serofuge					
Serofuge II	CAM101	CAB083			
Triac	CAM025	CAB018	RPC036	CAB018	RPC036
Triac II	CAM027	CAB018	RPC036	CAB018	RPC036

* This Cap (RPI Part #RPC036) only fits the RPI Motor (RPI Part #CAM026). This Cap does not fit the OEM Motor.

Models: Autocrit & Micro-Hematocrit

RPI Part #CAM115
OEM Part # 42055801

MOTOR & SPINDLE ASSEMBLY*

- 120VAC, 60 Hz.; 11,700 RPM (+22%, -10%)
- Includes motor, and mounting plate* (head adapter and aluminum mounting plate installed)
- Replacement Brush: RPI Part #CAB018;
- Replacement Cap: RPI Part #RPC036

Fits: Centrifuge housing

Models: Autocrit I & II, Autocrit Ultra III and Micro-Hematocrit I, II & III

*RPI offers one motor that fits all models, plus a FREE mounting plate!
About the mount plate: Since the head adapters on the old style motor assemblies cannot be removed on the Autocrit I & III and Micro-Hematocrit I & III, RPI will give you a **FREE** new mounting plate!

- Round style mounting plate fits the Autocrit I and Micro-Hematocrit I.
- Triangular style mounting plate fits the Autocrit III and Micro-Hematocrit III.
- Mounting plate that fits the Autocrit II and Micro-Hematocrit II comes standard with the RPI motor.

**LOOK...
ONE RPI MOTOR FITS
ALL MODELS!**

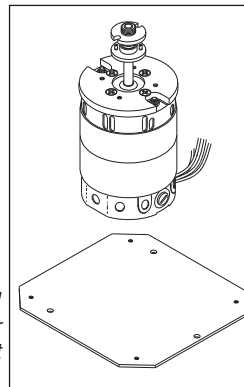

RPI Part #CAC048
OEM Part # N/A

MOTOR MOUNTING GASKET

Fits: Mounting Plate
Models: Autocrit & Micro-Hematocrit

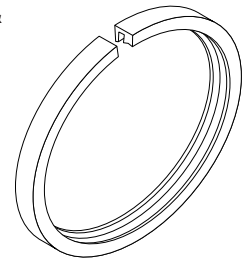

RPI Part #CAB017
New OEM Part #42055102
Old OEM Part #0551-600-001

BRUSH

- 2 per package
- Size: 9/32" x 9/32" x 3/4"
- Radius: 1/2"; Spring Length: 1-1/4"

Fits: Brush Holder Assembly on **older model**

OEM Motors

Models: Autocrit & Micro-Hematocrit

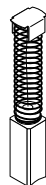

RPI Part #RPC037

BRUSH CAP WITH INSERT

- 6 per package
- 3/8-24 thread

Fits: Motor (RPI Part #CAM049)

Models: Autocrit & Micro-Hematocrit



New RPI Part #IEB024

Old RPI Part #DAB024

OEM Part # N/A

BRUSH

- 2 per package
- Size: 1/4" x 1/4" x 21/32"
- Radius: .725"
- Spring length: 1.0"; Copper shunt wire

Fits: Motor (RPI Part #CAM049, CAM050 & IEM025) only

Model: Autocrit & Micro-Hematocrit



RPI Part #CAS009
New OEM Part #42055113
Old OEM Part #0551-606-000

SHOCK MOUNT ASSEMBLY

- 4 assemblies per package
- Includes (4) #8-32 x 2" Phillips pan head screw, (4) #8 flat washer, (4) .265" ID x .500" OD x .062" THK flat washer, (4) #8-32 hex nut, (4) #8-32 flex lock nut, (4) spacer, (4) rubber ball mount, (8) split key ring, and (8) #8 external tooth washer
- All hardware stainless steel

Fits: Mounting Plate

Models: Autocrit & Micro-Hematocrit

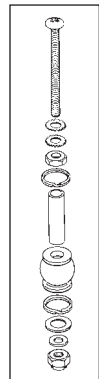

RPI Part #CAB018
OEM Part #42000102

BRUSH

- 2 per package
- Size: 1/4" x 1/4" x 3/4"
- Radius: 1.0"; Spring Length: 7/8"

Fits: Brush Holder Assembly

Models: Autocrit & Micro-Hematocrit

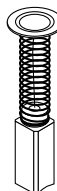

Call Us Toll-Free Monday-Friday, 8:00 AM-4:30 PM (Pacific Time), (800) 221-9723

Centrifuges

Models: Autocrit & Micro-Hematocrit (continued)

RPI Part #CAA001
OEM Part # N/A

HEAD ADAPTER ASSEMBLY

- Includes all parts as shown
- Fits:** Pressed on Shaft of Motor
- Models:** Autocrit & Micro-Hematocrit

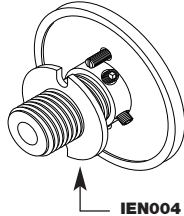

IAE004

RPI Part #CAK002
OEM Part # N/A

HEAD COVER KNOB ASSEMBLY

- Includes retaining ring
- Fits:** Head Adaptor
- Model:** Autocrit

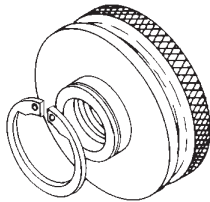

RPI Part #CAK003
OEM Part # N/A

HEAD COVER KNOB

- Fits:** Head Adaptor
- Model:** Micro-Hematocrit

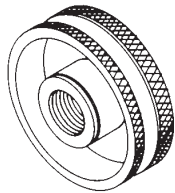

RPI Part #CAS052
New OEM Part #42055107
Old OEM Part #0551-602-000

SAFETY SWITCH

- DPDT
- 6A, 125VAC;
- 3A, 250VAC
- Mounts below latch assembly
- Models:** Autocrit & Micro-Hematocrit

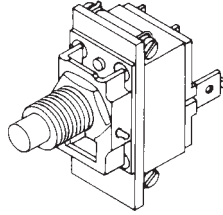

RPI Part #CAF014
New OEM Part #42055114
Old OEM Part #0551-607-000

SUCTION CUP FOOT

- 4 per package
- 3/4 high shoulder
- #8-32 x 3/8 stud
- Mounts to base plate
- Models:** Autocrit & Micro-Hematocrit

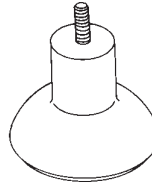

RPI Part #CAH032
New OEM Part #42055112
Old OEM Part #0551-605-001

RUBBER HEADLINER

- 3 per package
- Fits:** Head Assembly
- Models:** Micro-Hematocrit

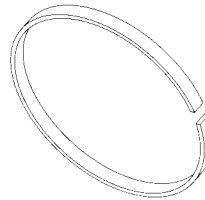

CAH032
CROSS SECTION

RPI Part #CAL033
New OEM Part #42058001
Old OEM Part #0580-607-000

RUBBER CARRYING TRAY LINER

- Models:** Autocrit

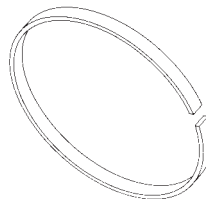

CAL033
CROSS SECTION

RPI Part #CAC015
New OEM Part #42054109
Old OEM Part #0541-603-000

POWER CORD

- 18/3 SJT, 10A@125V
- 60°C
- Includes grommet
- Length: 8 ft.
- Models:** Autocrit & Micro-Hematocrit

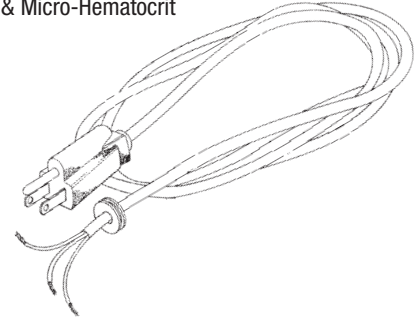

NOTES: _____

Cross section illustrations are actual size. Where practical, cut old part to match with cross section illustration.

RPI is your best source for quality replacement parts!

RPI Part #CAA053
OEM Part # N/A
HEAD ADAPTER ASSEMBLY
Fits: Pressed on Shaft of Motor
Models: Autocrit II & Micro-Hematocrit II



RPI Part #CAK002
OEM Part # N/A
HEAD COVER KNOB ASSEMBLY
 • Includes retaining ring
Fits: Shaft Adaptor
Model: Autocrit II

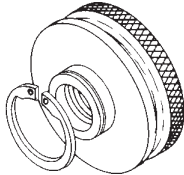

RPI Part #CAK003
OEM Part # N/A
HEAD COVER KNOB
Fits: Shaft Adaptor
Model: Micro-Hematocrit II

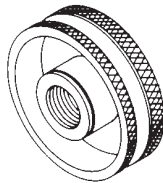

RPI Part #CAB017
New OEM Part #42055102
Old OEM Part #0551-600-001
BRUSH
 • 2 per package
 • Size: 9/32 x 9/32 x 3/4
 • Radius: 1/2"
 • Spring Length: 1-1/4"
Fits: Brush Holder Assembly
Models: Micro-Hematocrit II

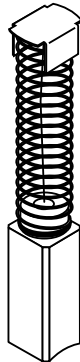

RPI Part #CAB018
New OEM Part #42000102
Old OEM Part #0001-600-001
BRUSH
 • 2 per package
 • Size: 1/4 x 1/4 x 3/4
 • Radius: 1.0"
 • Spring Length: 7/8"
Fits: Brush Holder Assembly
Models: Autocrit II & Micro-Hematocrit II

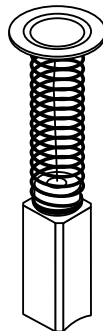

RPI Part #CAS051
New OEM Part #42055806
Old OEM Part #0558-602-000
SAFETY SWITCH
 • SPDT
 • 15A, 125VAC;
 10A, 250VAC;
 1/2HP, 250VAC
Fits: Control Panel
Models: Autocrit II & Micro-Hematocrit II

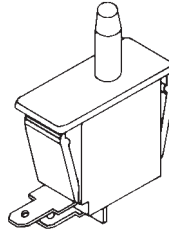

RPI Part #CAT074
New OEM Part #42055805
Old OEM Part #0558-601-000
ELECTRIC TIME SWITCH (15 MINUTES)
 • DPDT
 • 15A, 120-250VAC
 • Body of RPI timer is slightly larger than OEM's; *Inner dial* on OEM timer rotates to indicate time—*Outer dial* on RPI timer rotates to indicate time; Rewire per RPI instructions (included)
 • Includes timer, and face plate
Fits: Control Panel
Models: Autocrit II & Micro-Hematocrit II

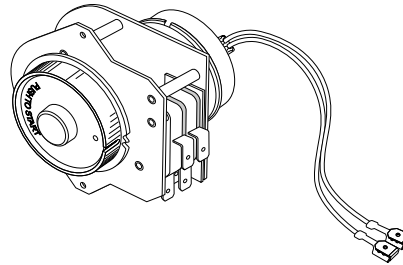

RPI Part #CAL082
New OEM Part #42010110 & 42055811
Old OEM Part #0101-606-000 & 0558-615-000

PILOT LIGHT
 • Red
 • 125VAC, 1/3W
Models: Autocrit II & Micro-Hematocrit II

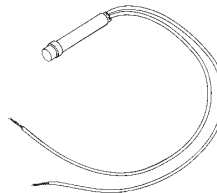

Quantity price breaks are available on all parts.

RPI Part #CAH032
New OEM Part #42055112
Old OEM Part #0551-605-001
RUBBER HEADLINER
 • 3 per package
Fits: Head Assembly
Models: Micro-Hematocrit II

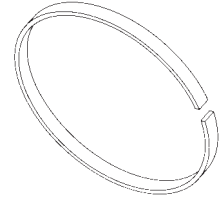

CAH032
 CROSS SECTION

RPI Part #CAL033
New OEM Part #42058001
Old OEM Part #0580-607-000
RUBBER CARRYING TRAY LINER
Models: Autocrit II

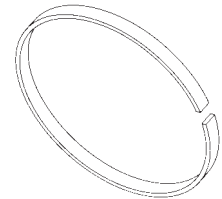

CAL033
 CROSS SECTION

RPI Part #CAL054
New OEM Part #42048003
Old OEM Part #0580-609-000

RUBBER HUB LINER
 • 3 per package
Fits: Hub Section of Carrying Tray
Models: Autocrit II & Micro-Hematocrit II

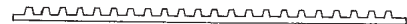

RPI Part #CAC015
New OEM Part #42054109
Old OEM Part #0541-603-000

POWER CORD
 • 18/3 SJT, 15A, 125V
 • Length: 8 ft.
Models: Autocrit II & Micro-Hematocrit II

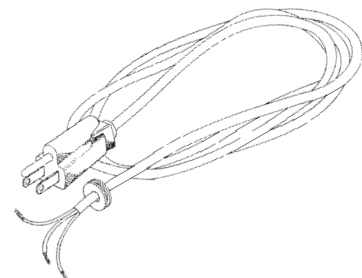

Centrifuges

Models: Autocrit Ultra III & Micro-Hematocrit III

RPI Part #CAM050
 New OEM Part #42057501
 Old OEM Part #0575-600-000

MOTOR ASSEMBLY

- Replaces motor with three dimensional mounting plate only—will not work with flat mounting plate
- 120VAC, 60 Hz., 11,700 RPM, +22%, -10%
- Body of RPI motor is slightly larger than OEM's; Requires RPI brushes; Rewire per RPI instructions (included)
- Includes motor, mounting plate, shaft adaptor, and spanner nut

Models: Autocrit Ultra III & Micro-Hematocrit III

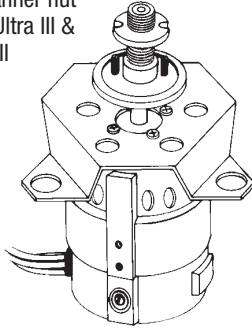

RPI Part #RPC037

BRUSH CAP WITH INSERT

- 6 per package
 - 3/8-24 thread
 - Fits: Motor (RPI Part #CAM050)
- Models: Autocrit Ultra III & Micro-Hematocrit III



RPI Part #CAA053
 OEM Part # N/A

HEAD ADAPTER ASSEMBLY

- Fits: Pressed on Shaft of Motor
- Models: Autocrit Ultra III & Micro-Hematocrit III

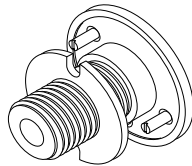

New RPI Part #IEB024
 Old RPI Part #DAB024
 OEM Part # N/A

BRUSH

- 2 per package
 - Size: 1/4 x 1/4 x 21/32
 - Radius: .725"
 - Spring length: 1.0"
 - Copper shunt wire
 - Fits: Motor (RPI Part #CAM049, CAM050 & IEM025) only
- Model: Autocrit, Autocrit Ultra III & Micro-Hematocrit III

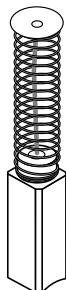

RPI Part #CAB017
 New OEM Part #42055102
 Old OEM Part #0551-600-001

BRUSH

- 2 per package
 - Size: 9/32 x 9/32 x 3/4
 - Radius: 1/2"
 - Spring Length: 1-1/4"
 - Fits: Brush Holder Assembly
- Models: Micro-Hematocrit III

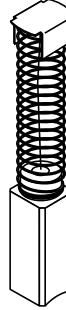

RPI Part #CAB018
 New OEM Part #42000102
 Old OEM Part #0001-600-001

BRUSH

- 2 per package
 - Size: 1/4 x 1/4 x 3/4
 - Radius: 1.0"
 - Spring Length: 7/8"
 - Fits: Brush Holder Assembly
- Models: Autocrit Ultra III & Micro-Hematocrit III

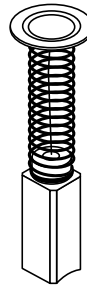

RPI Part #CAT074
 New OEM Part #42055805
 Old OEM Part #0558-601-000

ELECTRIC TIME SWITCH (15 MINUTES)

- DPDT
 - 15A, 120-250VAC
 - Body of RPI timer is slightly larger than OEM's; *Inner* dial on OEM timer rotates to indicate time —*Outer* dial on RPI timer rotates to indicate time; Rewire per RPI instructions (included)
 - Includes timer, and face plate
 - Fits: Control Panel
- Models: Autocrit Ultra III & Micro-Hematocrit III

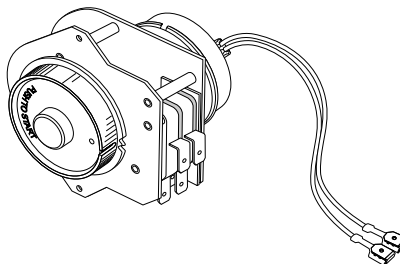

RPI Part #CAS051
 New OEM Part #42055806
 Old OEM Part #0558-602-000

SAFETY SWITCH

- SPDT
 - 15A, 125VAC; 10A, 250VAC; 1/2HP, 250VAC
 - Fits: Control Panel
- Models: Autocrit Ultra III & Micro-Hematocrit III

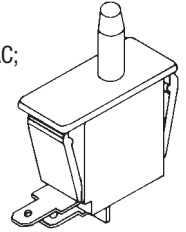

RPI Part #CAL082
 New OEM Part #42010110 & 42055811
 Old OEM Part #0101-606-000 & 0558-615-000

PILOT LIGHT

- Red
 - 125VAC, 1/3W
- Models: Autocrit Ultra III

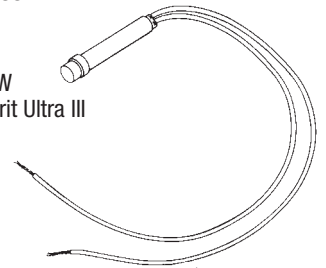

RPI Part #CAS052
 New OEM Part #42055107
 Old OEM Part #0551-602-000

SAFETY SWITCH

- DPDT
 - 6A, 125VAC; 3A, 250VAC
 - Mounts below latch assembly
- Models: Autocrit Ultra III

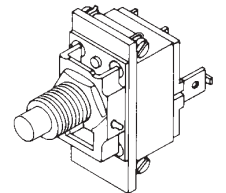

RPI Part #CAH032
 New OEM Part #42055112
 Old OEM Part #0551-605-001

RUBBER HEADLINER

- 3 per package
 - Fits: Head Assembly
- Models: Micro-Hematocrit III



CAH032 CROSS SECTION

Cross section illustrations are actual size. Where practical, cut old part to match with cross section illustration.

RPI Part #CAL033
New OEM Part #42058001
Old OEM Part #0580-607-000

RUBBER CARRYING TRAY LINER
Models: Autocrit Ultra III



CAL033
CROSS SECTION

RPI Part #CAL054
New OEM Part #42048003
Old OEM Part #0580-609-000

RUBBER HUB LINER
• 3 per package
Fits: Hub Section of Carrying Tray
Models: Autocrit Ultra III
& Micro-Hematocrit III



RPI Part #CAC015
New OEM Part #42054109
Old OEM Part #0541-603-000

POWER CORD
• 18/3 SJT, 15A, 125V
• Length: 8 ft.
Models: Autocrit Ultra III
& Micro-Hematocrit III

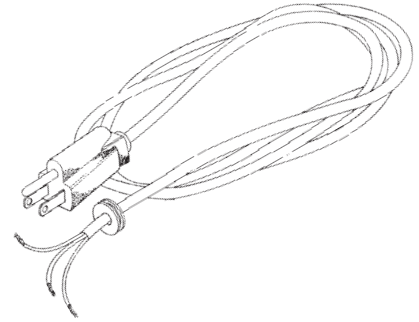

Cross section illustrations are actual size. Where practical, cut old part to match with cross section illustration.

Models: Dynac & Dynac II

RPI Part #CAM026
New OEM Part #42010101
Old OEM Part #0101-600-000

MOTOR ASSEMBLY
• 120VAC, 60 Hz., 3600 RPM max.
• Includes motor, gasket, and mounting hardware
• Use RPI Part #CAB019 for replacement brushes
Model: Dynac

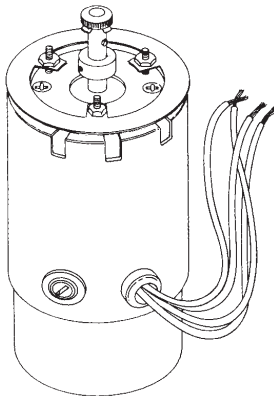

RPI Part #CAI080
New OEM Part #42010318
Old OEM Part #0103-612-000

VIBRATION ISOLATOR
• 3 per package
• Mounts on motor mounting plate
Model: Dynac II

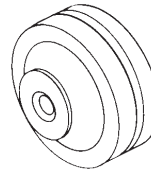

RPI Part #CAB019
OEM Part # N/A

BRUSH
• 2 per package
• Size: 1/4 x 1/4 x 3/4
• Radius: 1.0"
• Spring Length: 7/8"
Fits: Motor (RPI Part #CAM026) only
Model: Dynac

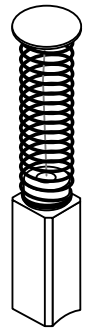

RPI Part #CAC016
New OEM Part #42010108
Old OEM Part #0101-605-000

SPEED CONTROL ASSEMBLY
• Includes speed control, knob, and mounting hardware
• Mounts to instrument panel
Model: Dynac

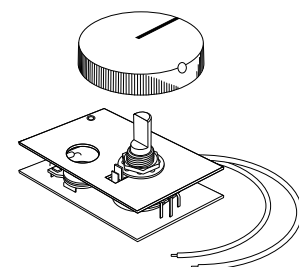

RPI Part #RPC036
BRUSH CAP WITH INSERT
• 6 per package
• 3/8-24 thread
Fits: Motor (RPI Part #CAM026)
Models: Dynac

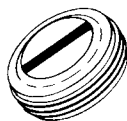

RPI Part #CAB018
New OEM Part #42000102
Old OEM Part #0001-600-001

BRUSH
• 2 per package
• Size: 1/4 x 1/4 x 3/4
• Radius: 1.0"
• Spring Length: 7/8"
Fits: Brush Holder Assembly
Models: Dynac & Dynac II

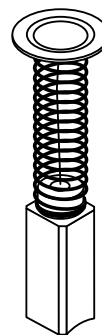

Centrifuges

Models: Dynac & Dynac II (continued)

RPI Part #CAC072
 New OEM Part #42010311
 Old OEM Part #0103-605-000

SPEED CONTROL

- Includes speed control, and mounting hardware
 - Mounts to instrument panel
- Model: Dynac II

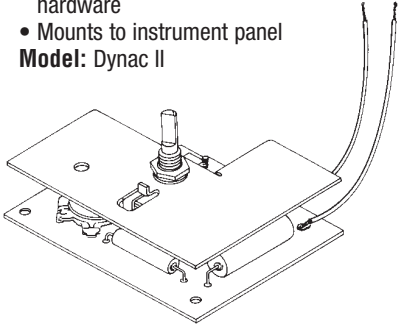

RPI Part #CAM078
 New OEM Part #42010317
 Old OEM Part #0103-610-000

TACH METER

- Mounts in control panel
- Model: Dynac II

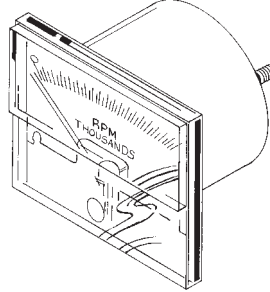

RPI Part #CAT044
 New OEM Part #42010103
 Old OEM Part #0101-601-000

MECHANICAL TIME SWITCH (30 minutes)

- SPST
- 15A, 120-240VAC;
- 1/3HP, 120-240VAC
- Includes timer with switch, knob, and mounting nut

Fits: Control Panel
 Model: Dynac

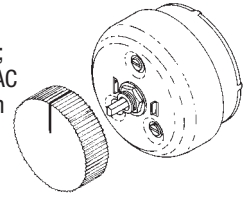

RPI Part #CAA075
 New OEM Part #42010320
 Old OEM Part #0103-614-000

TACHOMETER PC BOARD ASSEMBLY

- Mounts to base plate
- Model: Dynac II

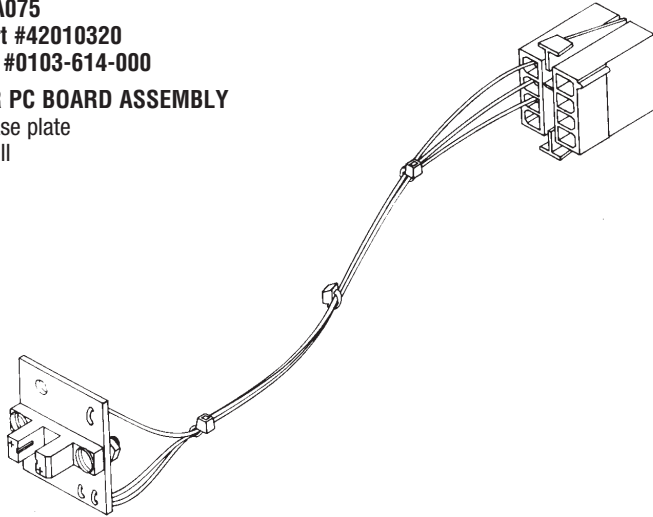

RPI Part #CAT062
 New OEM Part #42010304
 Old OEM Part #0103-601-001

ELECTRIC TIME SWITCH (30 minutes)

- SPDT
- 15A, 120-250VAC;
- 1/2HP, 120-250VAC

Fits: Control Panel
 Model: Dynac II

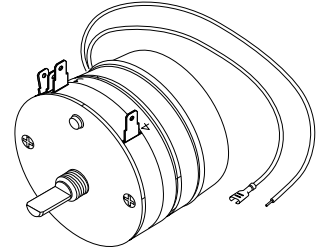

RPI Part #CAS079
 New OEM Part #42010313
 Old OEM Part #0103-607-000

SOLENOID ASSEMBLY

- Includes coupling
- Fits: Solenoid Bracket Assembly
 Model: Dynac II

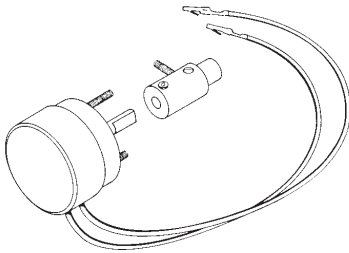

RPI Part #CAL082
 New OEM Part #42010110 & 42055811
 Old OEM Part #0101-606-000 & 0558-615-000

PILOT LIGHT

- Red
 - 125VAC, 1/3W
- Models: Dynac

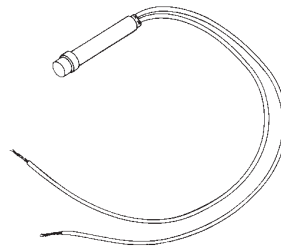

RPI Part #CAS043
 New OEM Part #42010105
 Old OEM Part #0101-602-000

BRAKE SWITCH

- DPDT
- Momentary
- 15A, 125VAC;
- 10A, 250VAC;
- 1/2HP, 250VAC

Fits: Control Panel
 Model: Dynac

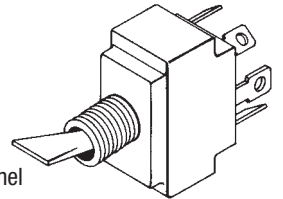

RPI Part #CAS063
 New OEM Part #42010306
 Old OEM Part #0103-602-001

POWER SWITCH

- SPDT
- 15A, 125VAC;
- 10A, 250VAC;
- 3/4HP, 125/250VAC

Fits: Control Panel
 Model: Dynac II

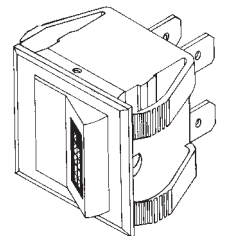

Orders placed before 2:00 P.M. (Pacific Time) will be shipped the same day.

RPI Part #CAS064
New OEM Part #42010307
Old OEM Part #0103-602-002

BRAKE SWITCH

- DPDT
- Momentary
- 15A, 125VAC;
- 10A, 250VAC

Fits: Control Panel
Model: Dynac II

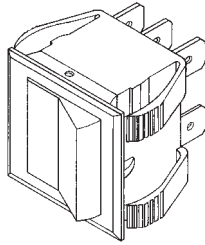

RPI Part #CAL004
New OEM Part #42010107
Old OEM Part #0101-604-001

LATCH SET

Fits: Cover Assembly
Models: Dynac & Dynac II

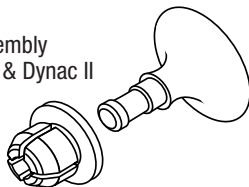

RPI Part #CAR095
New OEM Part #42010325
Old OEM Part #0103-621-100

K-2 RELAY

- 120V

Fits: Mounts to underside of control panel
Models: Dynac II

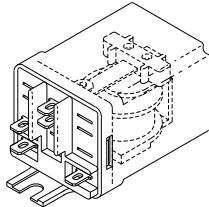

RPI Part #CAB005
New OEM Part #42010112
Old OEM Part #0101-608-000

RUBBER BUMPER

- 3 per package
 - Presses into lid
- Models: Dynac & Dynac II

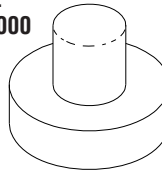

RPI Part #CAF056
New OEM Part #42010113
Old OEM Part #0101-609-000

RUBBER FOOT

- 4 per package
 - Steel washer molded in
 - Mounts to base plate
- Model: Dynac II

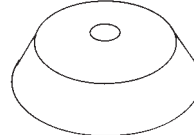

RPI Part #CAT093
New OEM Part #42010324
Old OEM Part #0103-620-100

STEPDOWN TRANSFORMER

- 120V step down to 24V
 - Mounts to underside of control panel
- Model: Dynac II

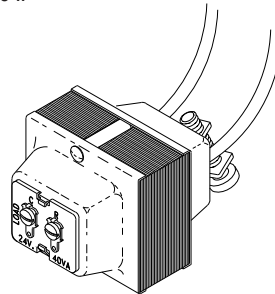

RPI Part #CAF013
New OEM Part #42010113
Old OEM Part #0101-609-000

RUBBER FOOT

- 3 per package
 - Steel washer molded in
 - Mounts to base plate
- Model: Dynac

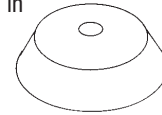

RPI Part #CAC015
New OEM Part #42054109
Old OEM Part #0541-603-000

POWER CORD

- 18/3 SJT, 15A, 125V
 - Length: 8 ft.
- Models: Dynac & Dynac II

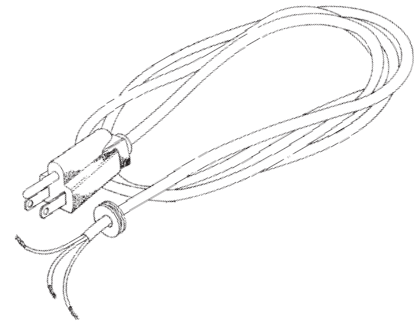

Model: QBC 4207

RPI Part #CAB021
New OEM Part #42059102
Old OEM Part #0591-600-001

BRUSH

- 2 per package
- Size: 3/16 x 3/16 x 5/8
- Radius: 3/4"
- Spring Length: 5/8"

Fits: Brush Holder Assembly
Models: QBC 4207 with "Jones" motor (Serial #185000 and above)

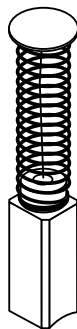

RPI Part #CAB022
New OEM Part #42059126
Old OEM Part #0591-640-001

BRUSH

- 2 per package
- Size: 1/4 x 1/4 x 1/2
- Radius: 5/8"
- Spring Length: 3/4"

Fits: Brush Holder Assembly
Model: QBC 4207 (Serial #184999 and below)



RPI Part #CAC015
New OEM Part #42054109
Old OEM Part #0541-603-000

POWER CORD

- 18/3 SJT, 15A, 125V
 - Length: 8 ft.
- Models: QBC 4207

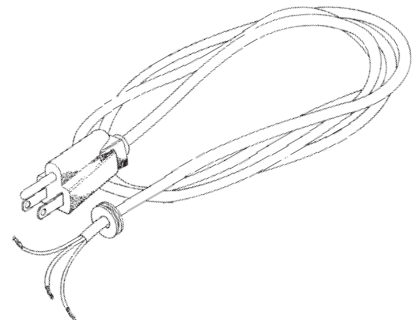

Unsurpassed quality is an RPI tradition.

Call Us Toll-Free Monday–Friday, 8:00 AM–4:30 PM (Pacific Time), (800) 221-9723

Centrifuges

Models: Readacrit & MP Readacrit

RPI Part #CAM024
New OEM Part #42059101
Old OEM Part #0591-600-000

MOTOR

- Motor is manufactured with bearings in place of oilite bushings
- 120VAC, 60 Hz., 8000 RPM ± 10%

Fits: Readacrit & MP Readacrit

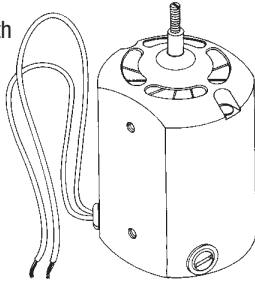

RPI Part #RPC039
BRUSH CAP WITH INSERT

- 6 per package
- 3/8-24 thread
- Fits:** Motor (RPI Part #CAM024)
- Models:** Readacrit & MP Readacrit

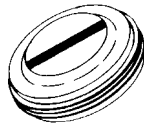

RPI Part #CAB021
New OEM Part #42059102
Old OEM Part #0591-600-001

BRUSH

- 2 per package
- Size: 3/16 x 3/16 x 5/8
- Radius: 3/4"
- Spring Length: 5/8"

Fits: Brush Holder Assembly
Models: Readacrit (Early model motor with slots top and bottom)

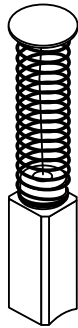

RPI Part #CAB022
New OEM Part #42059126
Old OEM Part #0591-640-001

BRUSH

- 2 per package
- Size: 1/4 x 1/4 x 1/2
- Radius: 5/8"
- Spring Length: 3/4"

Fits: Brush Holder Assembly
Model: Readacrit (Early model motor without slots top and bottom)

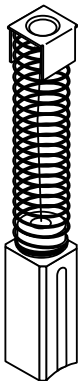

RPI Part #CAT045
New OEM Part #42059202
Old OEM Part #0592-601-000

MECHANICAL TIME SWITCH (5 minute)

- SPST
- 15A, 120-240VAC; 1/3HP, 120-240VAC
- Includes timer with switch, knob, and (4) screw

Fits: Front Panel or Conversion Kit
Models: Readacrit & MP Readacrit

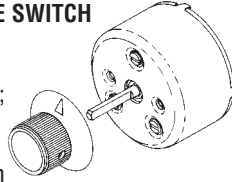

RPI Part #CAS040
New OEM Part #42059105
Old OEM Part #0591-602-000

SAFETY SWITCH ASSEMBLY

- SPDT
- 3A, 125VAC; 1A, 250VAC
- Mounts opposite ball catch assembly
- Includes switch, and insulator

Models: Readacrit & MP Readacrit (Old Style)

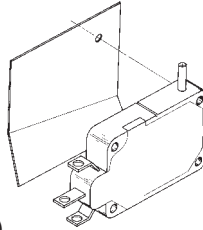

RPI Part #CAC006
New OEM Part #42059112
Old OEM Part #0591-605-000

BALL CATCH ASSEMBLY

- Mounts to exterior of body on units using old style latch assembly (OEM Part #0591-604-001)

Models: Readacrit & MP Readacrit

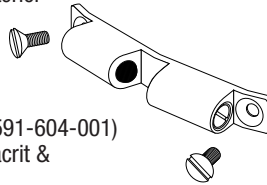

RPI Part #CAS041
New OEM Part #42059106
Old OEM Part #0591-602-101

SAFETY SWITCH ASSEMBLY

- SPST
- 10.1A, 125VAC; 1/4HP, 125VAC
- Mounts inside catch block
- Includes insulator, and stripped leads

Fits: New Style Catch Block and Latch
Models: Readacrit & MP Readacrit

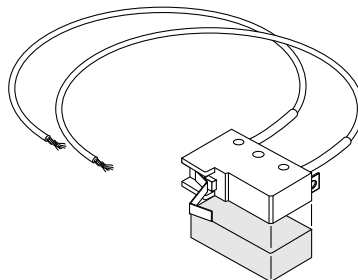

RPI Part #CAB076
New OEM Part #42059125
Old OEM Part #0591-622-100

CATCH BLOCK

- Mounts to exterior of body
- Models:** Readacrit & MP Readacrit

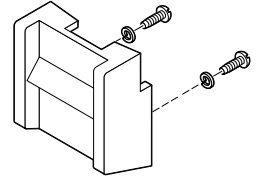

RPI Part #CAL077
New OEM Part #42059111
Old OEM Part #0591-604-101

LATCH ASSEMBLY

- Mounts on lid
- Models:** Readacrit & MP Readacrit

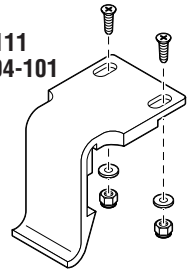

RPI Part #CAC086
New OEM Part #42059128
Old OEM Part #0591-604-100

LID COVER ASSEMBLY

- Includes Lid, Latch Assembly (RPI Part #CAL077) & Hinge Block
 - Mounts on centrifuge body
- Fits:** Guard
Models: Readacrit & MP Readacrit

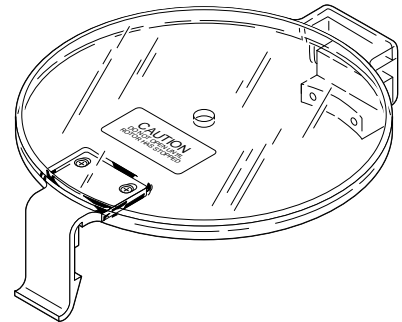

RPI Part #CAA073
New OEM Part #42059116
Old OEM Part #0591-609-000

HEAD ASSEMBLY

- When replacing this part, it is also a good time to replace the Rubber Cushion (RPI Part #CAC028)

Fits: Pressed on Shaft of Motor
Models: Readacrit & MP Readacrit

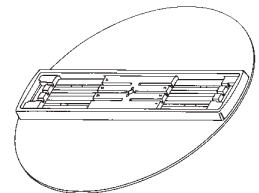

RPI Part #CAG007
New OEM Part #42059113
Old OEM Part #0591-606-000

GULLWING ASSEMBLY

- Includes gullwing, nylon washer, spring washer, knob and top section of locking cam
- When replacing this part, it is also a good time to replace the Rubber Cushion (RPI Part #CAC028)

Fits: Head Assembly
Models: Readacrit & MP Readacrit

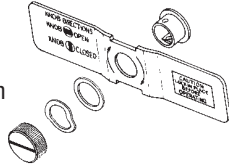

RPI Part #CAH008
New OEM Part #42059115
Old OEM Part #0591-608-000

HARDWARE ONLY / GULLWING

Fits: Gullwing Assembly and Motor Spindle
Models: Readacrit & MP Readacrit

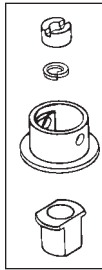

RPI Part #CAC028
New OEM Part #42059123
Old OEM Part #0591-617-000

RUBBER CUSHION

- 12 per package
- Fits:** Head Assembly
Models: Readacrit & MP Readacrit

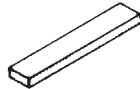

RPI Part #CAC029
New OEM Part #42059118
Old OEM Part #0591-611-000

RUBBER CHANNEL

Fits: Rim of Centrifuge Body under Lid Assembly
Models: Readacrit & MP Readacrit



CAC029
 CROSS SECTION

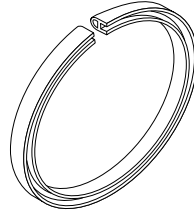

RPI Part #CAC055
OEM Part # N/A

RUBBER CUSHION

- 12 per package
- Fits:** Head Assembly
Models: Readacrit & MP Readacrit using Safe Tec® Non-Spill Tubes only

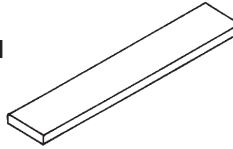

RPI Part #CAG081
New OEM Part #42059121
Old OEM Part #0591-615-000

RUBBER GROMMET

- 3 per package
- Fits:** Bottom Plate
Models: Readacrit & MP Readacrit

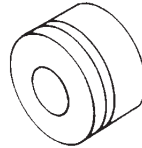

RPI Part #CAF012
New OEM Part #42059119
Old OEM Part #0591-613-000

SUCTION CUP FOOT

- 3 per package
 - Old style foot
 - 8-32 x 1/4 stud
 - Mounts to base plate
- Models:** Readacrit & MP Readacrit

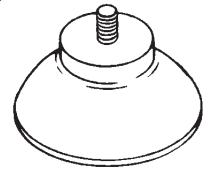

RPI Part #CAC015
New OEM Part #42054109
Old OEM Part #0541-603-000

POWER CORD

- 18/3 SJT, 15A, 125V
 - Length: 8 ft.
- Models:** Readacrit & MP Readacrit

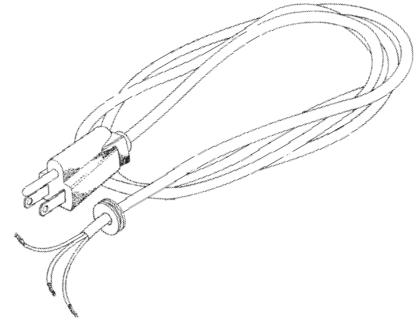

Models: Safeguard & Safety Head

RPI Part #CAB018
New OEM Part #42000102
Old OEM Part #0001-600-001

BRUSH

- 2 per package
 - Size: 1/4 x 1/4 x 3/4
 - Radius: 1.0"
 - Spring Length: 7/8"
- Fits:** Brush Holder Assembly
Models: Safeguard & Safety-Head

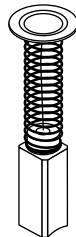

RPI Part #CAB020
OEM Part # N/A

BRUSH

- 2 per package
 - Size: 1/4 x 1/4 x 3/4
 - Radius: 3/4"
 - Spring Length: 1.0"
- Fits:** Brush Holders with External Brush Caps
Models: Older Safeguards & Safety-Heads

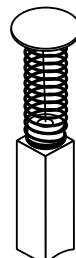

RPI Part #CAF010
New OEM Part #42000106
Old OEM Part #0001-609-000

SUCTION CUP FOOT

- 3 per package
 - 8-32 x 3/8 stud
 - Mounts to base plate
- Models:** Safeguard & Safety-Head

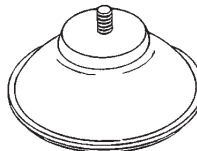

RPI Part #CAC015
New OEM Part #42054109
Old OEM Part #0541-603-000

POWER CORD

- 18/3 SJT, 15A, 125V
 - Length: 8 ft.
- Models:** Safeguard & Safety-Head

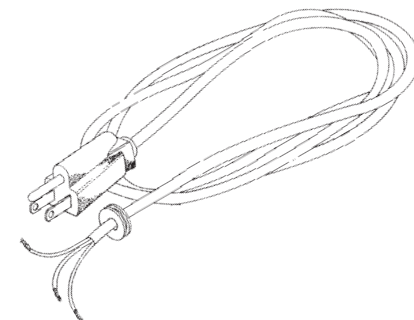

Cross section illustrations are actual size. Where practical, cut old part to match with cross section illustration.

Centrifuges

Models: Sero-Fuge & Sero-Fuge II

RPI Part #CAL077
New OEM Part #42059111
Old OEM Part #0591-604-101

LATCH ASSEMBLY

- Mounts on lid
- Models:** Sero-Fuge & Sero-Fuge II

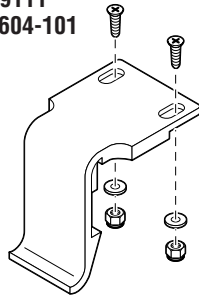

RPI Part #CAC087
OEM Part #0541-604-000

LID COVER ASSEMBLY

- Includes lid, latch assembly (RPI Part #CAL077) and hinge block
- Fits:** Guard
- Models:** Sero-Fuge & Sero-Fuge II

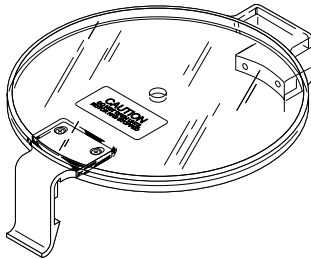

RPI Part #CAS041
New OEM Part #42059106
Old OEM Part #0591-602-101

SAFETY SWITCH ASSEMBLY

- SPST
- 10.1A, 125VAC; 1/4HP, 125VAC
- Mounts inside catch block
- Includes insulator, and stripped leads
- Fits:** New Style Catch Block and Latch
- Models:** Sero-Fuge II

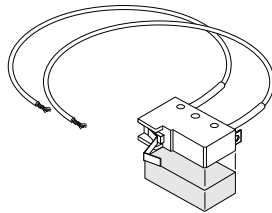

RPI Part #CAS069
New OEM Part #42052102
Old OEM Part #0521-602-000

HOLD SWITCH

- DPDT
- 3A, 125VAC; 1A, 250VAC
- Fits:** Control Panel
- Model:** Sero-Fuge

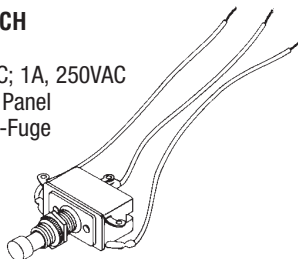

RPI Part #CAT071
New OEM Part #42054105
Old OEM Part #0541-601-000

TIMER

- 5 minute timer
- Includes knob (RPI Part #CAK111)
- 120VAC, 60Hz, 20 AMP rating
- Accurate to ±2% full scale
- 3/16 shaft
- Fits:** Front Panel
- Model:** Sero-Fuge II Only

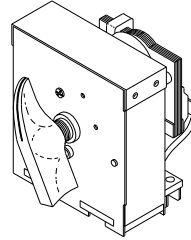

RPI Part #CAT067
New OEM Part #42052101
Old OEM Part #0521-601-000

ELECTRIC TIME SWITCH

- 5 minute
- SPST
- 15A, 120–250VAC; 1/2HP, 120–250VAC
- Fits:** Control Panel
- Model:** Sero-Fuge

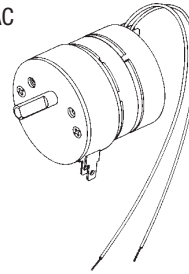

RPI Part #CAM101
New OEM Part #42054101
Old OEM Part #0541-600-000

MOTOR (115V)

- 115V/60Hz.
- Shaded pole
- -1.8 AMP current draw
- Two speeds: 3000 RPM @ "HIGH" and 2400 RPM @ "LOW"
- Fits:** Mounting holes under guard bowl
- Model:** Sero-Fuge II

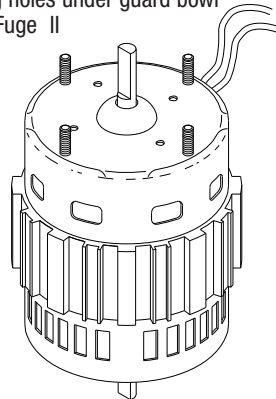

RPI Part #CAB083
New OEM Part #42054129
Old OEM Part #0541-613-000

REPLACEMENT BRUSH

- 2 per package
- Fits:** Governor brush carrier
- Model:** Sero-Fuge II



RPI Part #CAK111
New OEM Part #42054106
Old OEM Part #0541-601-001

TIMER KNOB

- Fits Sero-Fuge II timer with 3/16 round shaft
- Fits:** Timer shaft
- Model:** Sero-Fuge II Only

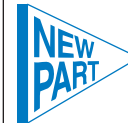
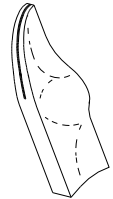

RPI Part #CAG091
New OEM Part #42054103
Old OEM Part #0541-600-005

GOVERNOR ASSEMBLY

- Mounts to bottom shaft of motor
- Fits:** Motor Base
- Model:** Sero-Fuge II

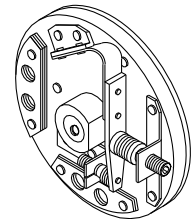

RPI Part #CAC089
New OEM Part #42054102
Old OEM Part #0541-600-004

BRUSH CARRIER

- Includes (2) brushes (RPI Part #CAB083)
- Fits:** Motor Base
- Model:** Sero-Fuge II

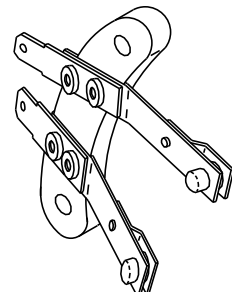

RPI Part #CAC098
 New OEM Part #42053103
 Old OEM Part #0531-600-003

CAPACITOR
 • .68 MFD, 400V
Fits: Braking Resistor Assembly
Models: Sero-Fuge II

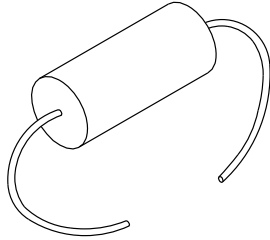

RPI Part #CAR096
 New OEM Part #42053102
 Old OEM Part #0531-600-002

VOLTAGE RECTIFIER
 • Industry Standard No. IN4004
Fits: Braking resistor assembly
Models: Sero-Fuge II

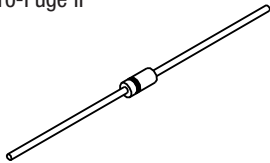

RPI Part #CAR097
 New OEM Part #42053101
 Old OEM Part #0531-600-001

BRAKING RESISTOR
 • Wirewound fixed power
 • 150 OHM, 50W
Fits: Braking resistor assembly
Models: Sero-Fuge II

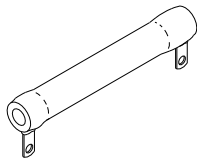

RPI Part #CAC036
 New OEM Part #42052104
 Old OEM Part #0521-608-001

RUBBER CHANNEL
 • Mounts on guard assembly
 under lid assembly
Models: Sero-Fuge
 & Sero-Fuge II



RPI Part #CAS090
 New OEM Part #42054121
 Old OEM Part #0541-614-100

BASE-RUBBER SEAL (NEW STYLE)
 • Includes base-rubber seal and
 (6) stato seals
Fits: Bottom of guard
Model: Sero-Fuge II

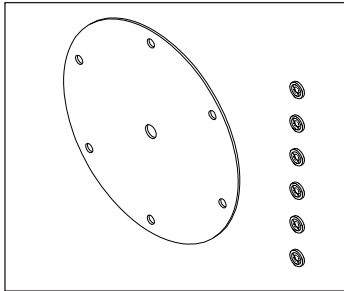

RPI Part #CAS068
 New OEM Part #42054107
 Old OEM Part #0541-602-000

BRAKE SWITCH
 • DPDT
 • Momentary
 • 6A, 125VAC; 3A, 250VAC
Fits: Control Panel
Model: Sero-Fuge II

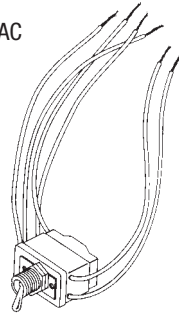

RPI Part #CAL092
 New OEM Part #42052601
 Old OEM Part #0526-609-000

RUBBER STRIP LINER - 6 PLACE HEAD
Fits: Head assembly
Model: Sero-Fuge

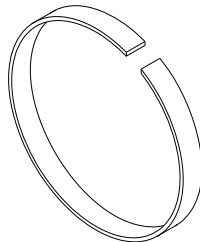

Cross section illustrations are actual size. Where practical, cut old part to match with cross section illustration.

RPI Part #CAC015
 New OEM Part #42054109
 Old OEM Part #0541-603-000

POWER CORD
 • 18/3 SJT, 15A, 125V
 • Length: 8 ft.
Model: Sero-Fuge
 & Sero-Fuge II

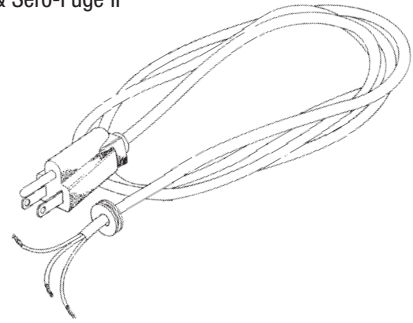

RPI Part #CAS070
 New OEM Part #42054119
 Old OEM Part #0541-611-000

HI-LOW SWITCH
 • SPST
 • 6A, 125VAC;
 3A, 250VAC
Fits: Control Panel
Model: Sero-Fuge II



RPI Part #CAF109
 New OEM Part #4254116
 Old OEM Part #0541-608-000

FOOT KIT WITH HARDWARE
 • Includes all mounting hardware: 4
 of each part per package
 • 60 shore black rubber
Fits: Bottom plate
Model: Sero-Fuge & Sero-Fuge II

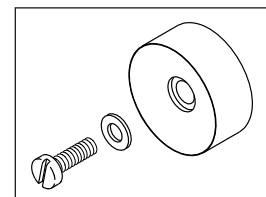

Visit the RPI website
www.rpiparts.com

Centrifuges

Model: Triac

RPI Part #CAM025
 New OEM Part #42020001
 Old OEM Part #0200-600-000

MOTOR ASSEMBLY

- 120VAC, 60 Hz., 10,300 RPM max.
- Includes motor, collar, and pin
- When replacing this motor, it is also a good time to replace the Motor Gasket (RPI Part #CAG034)

Model: Triac (Serial #144999 and below)

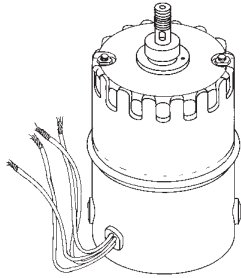

RPI Part #RPC037

BRUSH CAP WITH INSERT

- 6 per package
- 3/8-24 thread

Fits: Motor (RPI Part #CAM025)

Models: Triac (Serial #144999 and below)



RPI Part #CAM027
 New OEM Part #42021001
 Old OEM Part #0210-600-000

MOTOR ASSEMBLY

- 120VAC, 60 HZ., 10,300 RPM max.
- Includes motor, collar, pin, and reductor gear
- When replacing this motor, it is also a good time to replace the Motor Gasket (RPI Part #CAG034)

Model: Triac (Serial #145000 and above)

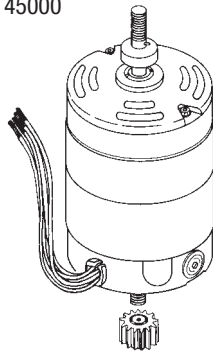

RPI Part #RPC036

BRUSH CAP WITH INSERT

- 6 per package
- 3/8-24 thread

Fits: Motor (RPI Part #CAM027)

Models: Triac (Serial #145000 and above)

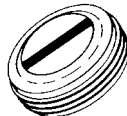

RPI Part #CAG034
 New OEM Part #42020003
 Old OEM Part #0200-600-050

MOTOR GASKET

Fits: Thru Hole in Centrifuge Body

Model: Triac

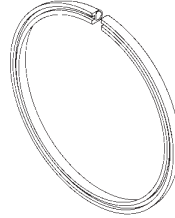

Cross section illustrations are actual size. Where practical, cut old part to match with cross section illustration.

RPI Part #CAB018
 New OEM Part #42000102
 Old OEM Part #0001-600-001

BRUSH

- 2 per package
- Size: 1/4 x 1/4 x 3/4
- Radius: 1.0"
- Spring Length: 7/8"

Fits: Brush Holder Assembly

Model: Triac

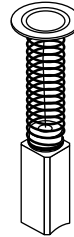

RPI Part #CAG035
 New OEM Part #42020008
 Old OEM Part #0200-604-001

COVER GASKET

Fits: Groove in Centrifuge Body

Model: Triac

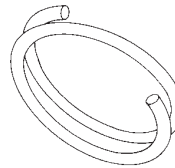

RPI Part #CAF011
 New OEM Part #42020013
 Old OEM Part #0200-608-

RUBBER FOOT

- 4 per package
- Steel washer molded in
- Mounts to base plate

Model: Triac (Serial #144999 and below)



RPI Part #CAC030
 New OEM Part #42020017
 Old OEM Part #0200-617-000

GASKET (MCHT TUBE)

- 8 per package
- Fits: Head Assembly

Model: Triac

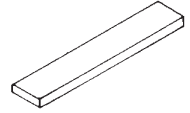

RPI Part #CAC031
 New OEM Part #42020015
 Old OEM Part #0200-610-000

TRUNNION CUSHION

- 8 per package
- Fits: Trunnion

Model: Triac



RPI Part #CAT066
 New OEM Part #42020004
 Old OEM Part #0200-601-000

ELECTRIC TIME SWITCH (15 minute)

- SPDT
- 15A, 120-250VAC
- Body of RPI timer is slightly larger than OEM's; *Inner* dial on OEM timer rotates to indicate time—*Outer* dial on RPI timer rotates to indicate time; Rewire per RPI instructions (included)
- Includes timer, and face plate

Fits: Control Panel

Model: Triac

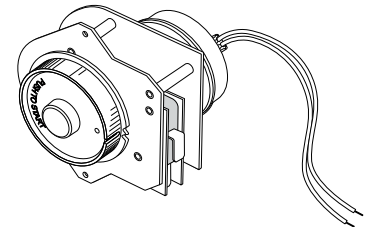

RPI Part #CAC015
 New OEM Part #42054109
 Old OEM Part #0541-603-000

POWER CORD

- 18/3 SJT, 15A, 125V
- Length: 8 ft.

Model: Triac

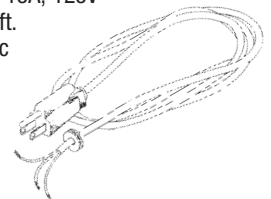

RPI Part #CAM102
New OEM Part #42022501
Old OEM Part #0226-600-001

MOTOR ASSEMBLY

- 120VAC, 1.5 AMP, 60Hz.
(Working range 110-130 VAC)
 - 3200 RPM +400 -140 RPM
- Fits:** Base plate
Models: Compact II

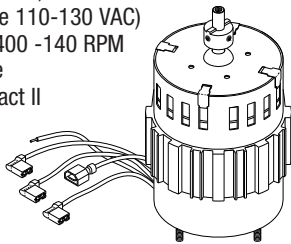

RPI Part #AIC058
OEM Part #42022506

MOTOR START CAPACITOR

- 6.0 Microfarad
 - Matchbox style
- Fits:** Base plate
Models: Compact II

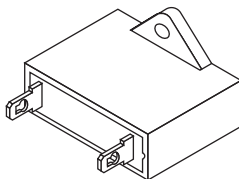

RPI Part #CAC110
New OEM Part #42022507
Old OEM Part #0225-601-030

WIRE CLAMPS

- 3 per package
 - Nylon®
 - Wire clamps are re-useable
- Fits:** Base plate
Model: Compact II

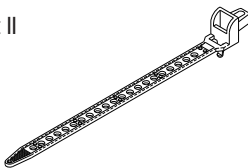

RPI Part #CAS106
New OEM Part #42022508
Old OEM Part #0225-603-000

SAFETY SWITCH

- Switch: 125/250VAC, 10.1 AMP
 - Includes switch, wire and insulated connectors
- Fits:** Under rear of lid
Model: Compact II

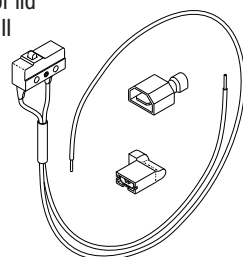

RPI Part #CAT104
New OEM Part #42022505
Old OEM Part #0225-601-013

MECHANICAL TIME SWITCH

- 30 minute with bell and knob
 - SPDT
 - 120VAC, 15 AMP
 - ±5% accuracy
 - Two-hole mount with manual override hold position
- Fits:** Front panel of centrifuge
Model: Compact II

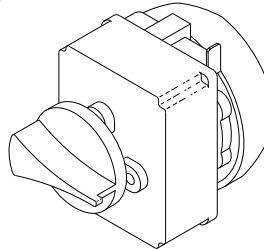

RPI Part #CAS103
New OEM Part #42015103
Old OEM Part #0151-607-000

HEAD SCREW ASSEMBLY

- Aluminum
 - Includes finger washer and retaining ring
- Fits:** Shaft of motor
Model: Analytical & Compact II

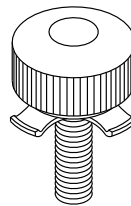

RPI Part #CAD108
New OEM Part #42015102
Old OEM Part #0151-600-010

MOTOR DRIVE ASSEMBLY

- Brass
 - Includes motor drive and (2) set screws (RPI Part #RPH201)
- Fits:** Motor Shaft
Models: Analytical, Compact II & Physician's Compact

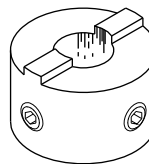

RPI Part #CAS042
New OEM Part #42012302
Old OEM Part #0123-602-000

ON/OFF SWITCH ASSEMBLY

- Replaces new style switch only
 - SPDT
 - 3A, 125VAC; 1A, 250VAC
- Fits:** Control Panel
Models: Analytical, Physician's Compact, Physician's Jr. & Yankee Rotator

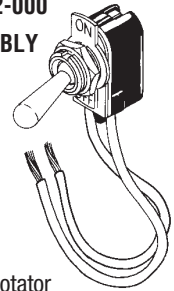

RPI Part #CAB023
OEM Part #0121-600-001

BRUSH

- 2 per package
 - Size: 3/16 x 3/16 x 5/8
 - Spring Length: 1-1/4"
- Fits:** Brush Holder Assembly
Model: Physician's Junior

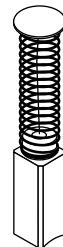

RPI Part #CAF010
New OEM Part #42000106
Old OEM Part #0001-609-000

SUCTION CUP FOOT

- 3 per package
 - 8-32 x 3/8 stud
 - Mounts to base plate
- Models:** Analytical, Physician's Compact & Physician's Jr

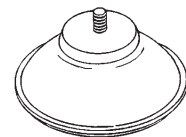

RPI Part #CAC015
New OEM Part #42054109
Old OEM Part #0541-603-000

POWER CORD

- 18/3 SJT, 15A, 125V
 - Length: 8 ft.
- Models:** Analytical, Cyclomixer, Physician's Compact, Physician's Jr., Yankee Pipette Shaker & Yankee Rotator

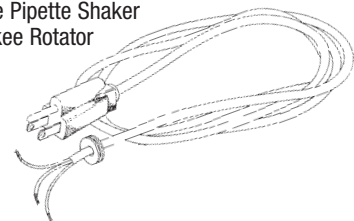

Place Your Order
24x7 via E-Mail
order@rpiparts.com

RPI Part #HBC003
OEM Part #V6105

CAPACITOR

- 4 MFD, 370VAC
- Matchbox style
- Fits:** Bottom mounting plate
- Models:** VanGuard V-6000 & V-6500

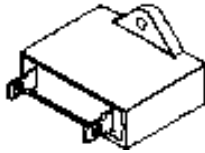

RPI Part #HBL004
OEM Part #V6145

INDICATOR LAMP

- Lamp rated @ 125VAC
- Fits:** Front panel cut-out
- Models:** VanGuard V-6500

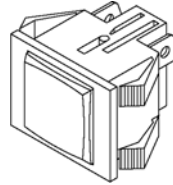

RPI Part #HBM011
OEM Part #V6125

POWER MODULE

- 125/250VAC, 15 AMP
- Fits:** Cut-out in rear chassis panel
- Models:** VanGuard V-6000 & V-6500

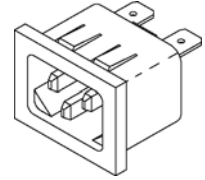

RPI Part #HBF010
OEM Part #V6135

SUCTION CUP FOOT

- 4 per package
- 1-3/4 cup with 8-32 x 3/8 stud
- Fits:** Mounting holes in base of chassis plate
- Models:** VanGuard V-6000 & V-6500



RPI Part #HBM001
OEM Part #V6100

MOTOR

- 115VAC, 60Hz, .67 AMP
- 3400 RPM, .05HP
- Includes motor mounts and clamping knob with tach pickup label
- Fits:** Mounting holes in base of centrifuge
- Models:** VanGuard V-6000 & V-6500

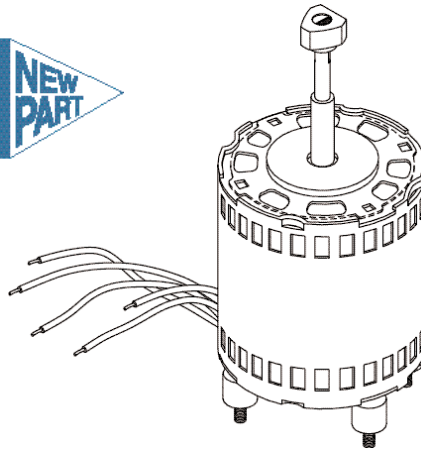

RPI Part #HBS006
OEM Part #V6130

LID SAFETY SWITCH

- 125/250VAC, 10 AMP
- Fits:** Mounting holes in rear panel
- Models:** VanGuard V-6000 & V-6500

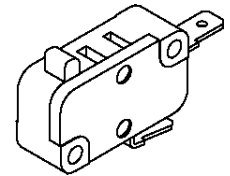

RPI Part #HBK007
OEM Part #V6115

CLAMPING KNOB

- 1/4-20 thread
- Includes tachometer pick-up label
- Fits:** External threads of motor shaft
- Models:** VanGuard V-6000 & V-6500

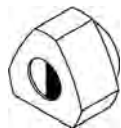

RPI Part #HBT002
OEM Part #V6070

MECHANICAL TIME SWITCH

- 60 minute with bell and knob
- SPDT
- 120VAC, 14 AMP
- ±5% accuracy
- Fits:** Front mounting plate
- Model:** VanGuard

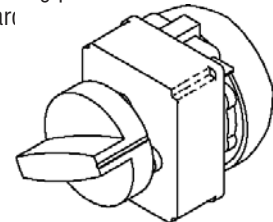

RPI Part #HBK008
OEM Part #V6175

TIMER KNOB

- Fits 1/4 diameter shaft with a flat
- Fits:** Timer shaft
- Models:** VanGuard V-6500



RPI Part #HBM009
OEM Part #V6150

MOTOR MOUNT

- 4 per package
- Black rubber
- 8-32 internal and external threads
- Fits:** Mounting studs on bottom of motor
- Models:** VanGuard V-6000 & V-6500

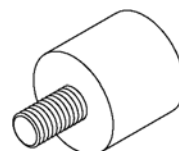

RPI Part #RPC262

POWER CORD

- 10 feet
- Plug NEMA 5-15
- Connector IEC320 C-13
- Cord rated @ 15 AMP
- Specifically for equipment with IEC320 C-14 power inlet modules

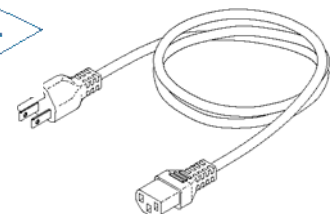

New RPI Part #IEM025
Old RPI Part #DAM025
OEM Part #1875

MOTOR ASSEMBLY

- 115 VAC, 50/60 cycles
- Minimum Speed: 11,500 RPM
- Includes Head Adapter Assembly (RPI Part #IEA001)
- When replacing this part, it is also a good time to replace the Motor Shock Mount Assembly (RPI Part #IES020)

Model: MB Micro-Hematocrit

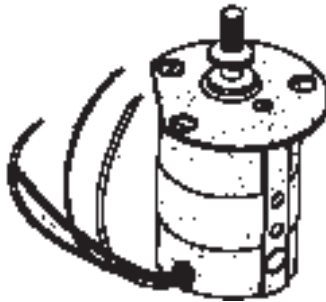

RPI Part #RPC037

BRUSH CAP WITH INSERT

- 6 per package
- 3/8-24 thread
- Fits:** Motor (RPI Part #IEM025)
- Models:** MB Micro-Hematocrit



New RPI Part #IEB008
Old RPI Part #DAB008
OEM Part #1840

BRUSH

- 2 per package
- Size: 7/32 x 5/16 x 5/8"
- Radius: 3/8"
- Spring length: 1.0"
- Copper shunt wire
- Fits:** Brush Holder Assembly
- Model:** MB Micro-Hematocrit



New RPI Part #IEB024
Old RPI Part #DAB024
OEM Part # N/A

BRUSH

- 2 per package
- Size: 1/4 x 1/4 x 21/32"
- Radius: .725"
- Spring length: 1.0"
- Copper shunt wire
- Fits:** Motor (RPI Part #CAM049, CAM050 & IEM025) only
- Model:** MB Micro-Hematocrit



New RPI Part #IEF022
Old RPI Part #DAF022
OEM Part #1884

FOOT

- 4 per package
- Fits:** Bottom Plate
- Model:** MB Micro-Hematocrit

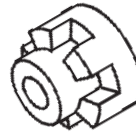

New RPI Part #IEA001
Old RPI Part #DAA001
OEM Part #7915B

HEAD ADAPTER ASSEMBLY

- Includes head adapter, (2) 10-32 x 1/8 stainless steel set screw, and (2) stainless steel pin
- Fits:** Shaft of Motor
- Model:** MB Micro-Hematocrit

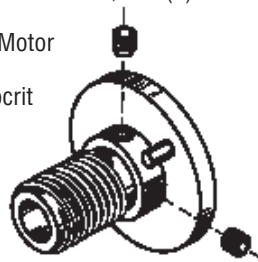

New RPI Part #IEK006
Old RPI Part #DAK006
OEM Part # N/A

HEAD ADAPTER KIT

- Includes head adapter, head cover nut, nylon® washer, head adapter nut, and retainer ring
- Fits:** Shaft of Motor
- Model:** MB Micro-Hematocrit

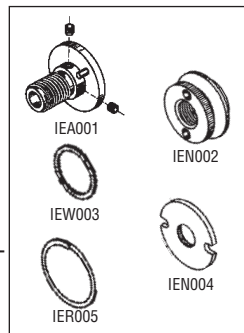

New RPI Part #IEC016
Old RPI Part #DAC016
OEM Part #1505

RUBBER CUSHION

- Size: 3/16 x 1/16 x 25"
- Fits:** Rotor Head
- Model:** MB Micro-Hematocrit

IEC016
CROSS SECTION

New RPI Part #IES020
Old RPI Part #DAS020
OEM Part #30882, 30888 & 30992

MOTOR SHOCK MOUNT ASSEMBLY

- 3 per package
- Includes (3) rubber isolator, (3) sleeve, and (6) washer
- Fits:** Motor Mounts of Drive Motor
- Model:** MB Micro-Hematocrit

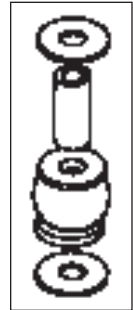

New RPI Part #IEN002
Old RPI Part #DAN002
OEM Part #7913

HEAD COVER NUT

- Fits:** Head Adapter
- Model:** MB Micro-Hematocrit



New RPI Part #IEN004
Old RPI Part #DAN004
OEM Part #7915B

HEAD ADAPTER NUT

- Fits:** Head Adapter
- Model:** MB Micro-Hematocrit



New RPI Part #IER005
Old RPI Part #DAR005
OEM Part #30012

RETAINER RING

- Fits:** Head Adapter
- Model:** MB Micro-Hematocrit

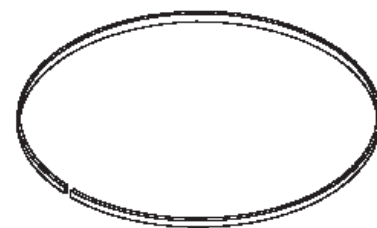

Cross section illustrations are actual size. Where practical, cut old part to match with cross section illustration.

Centrifuges

Models: MB Micro-Hematocrit (continued)

New RPI Part #IES021
Old RPI Part #DAS021
OEM Part #9942

SAFETY SWITCH

- SPDT
- 20A, 125V, 250V, 450VAC;
- 25A, 250VDC; 50A, 125VDC

Model: MB Micro-Hematocrit

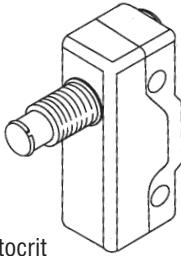

New RPI Part #IES026
Old RPI Part #DAS026
OEM Part # N/A

BRAKE SWITCH

- SPDT
- 10A, 125VAC-DC;
- 1/4 HP, 125VAC-DC

Model: MB Micro-Hematocrit

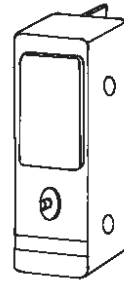

New RPI Part #IEW003
Old RPI Part #DAW003
OEM Part #30897

NYLON® WASHER

- Fits: Head Adapter

Model: MB Micro-Hematocrit



New RPI Part #IES023
Old RPI Part #DAS023
OEM Part #1880

BRAKE SWITCH ASSEMBLY

- DPDT
- 10A, 125VAC-DC;
- 1/4 HP, 125VAC-DC

Model: MB Micro-Hematocrit

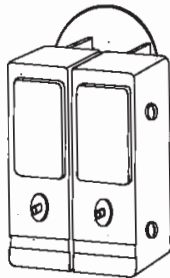

New RPI Part #IET019
Old RPI Part #DAT019
OEM Part #768

MECHANICAL TIME SWITCH (15 minute)

- SPST
- Switch: 20A, 120–240VAC
- Includes time switch, mounting hardware, and knob

Model: MB Micro-Hematocrit

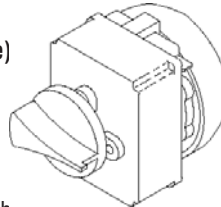

Visit the RPI website:
www.rpiparts.com

Model: Spinette

New RPI Part #IEB040
OEM Part #45985

CATCH BRACKET ASSEMBLY

- Includes hardware and mounting plate
- Fits: Mounting holes in lid
Model: Spinette

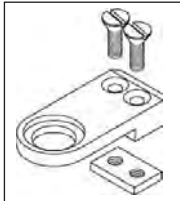

New RPI Part #IEP039
OEM Part #49658

SPRING LOADED PLUNGER

- Fits: Mounting holes in catch bracket

Model: Spinette



New RPI Part #IES045
OEM Part #46611

ROCKER POWER SWITCH

- SPST
 - 115VAC, 16 AMP
- Fits: Front panel cut-out
Model: Spinette



New RPI Part #IEM044
OEM Part #46620

MOTOR

- 1/30 horsepower
- 120VAC ±10%; 60Hz.
- -1.5 AMP current draw
- 3400 RPM ±200 RPM

Fits: Mounting holes in bottom mounting plate
Model: Spinette

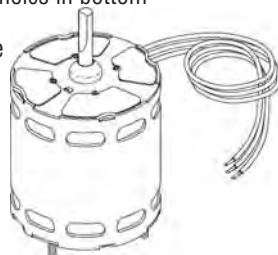

New RPI Part #IEP046
OEM Part #46647

VENT PLATE

- 18 gage perforated stainless steel
 - Includes hardware
- Fits: Mounting studs in base plate
Model: Spinette

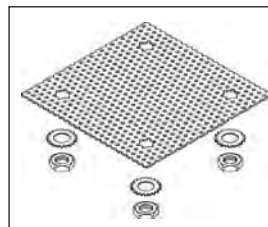

New RPI Part #IEC042
OEM Part #46621

POWER CORD

- 6 feet long
 - Includes strain relief bushing
 - 13 AMP
- Fits: Mounting holes at bottom rear of centrifuge
Model: Spinette

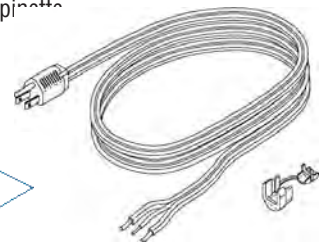

Models: B20A, Centra-7, Centra-7R, CH, CL, CM, CRU5000, CS, CU5000, DPR6000, H, HN, HNS, HNSII, HT, K Size 2, PR-J, PR-6, PR-6000 & UV

New RPI Part #IEB007
Old RPI Part #DAB007
OEM Part #1780

BRUSH

- 2 per package
- Size: 1/4 x 1/4 x 7/8"
- Radius: 1.0"
- Spring length: 2.0"
- No shunt wire

Fits: Brush Holder Assembly
Models: CH, CL, H, HN, HNS & HNSII



New RPI Part #IEB011
Old RPI Part #DAB011
OEM Part #40069

BRUSH

- 2 per package
- Size: 1/4 x 5/8 x 1-1/8"
- Radius: 1.0"
- Spring length: 1-1/2"
- Copper shunt wire

Fits: Brush Holder Assembly
Models: PR-J & PR-6



New RPI Part #IEM017
Old RPI Part #DAM017
OEM Part #7488

MOTOR MOUNT

Fits: Mounting Plate of Motor
Model: UV

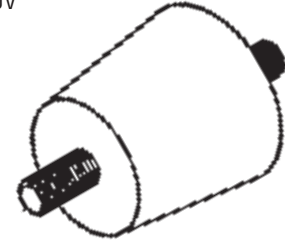

New RPI Part #IEB009
Old RPI Part #DAB009
OEM Part #1913

BRUSH

- 2 per package
- Size: 1/4 x 5/8 x 1-1/8"
- Radius: 1.0"
- Spring length: 1-3/8"
- Copper shunt wire

Fits: Brush Holder Assembly
Model: K Size 2



New RPI Part #IEB012
Old RPI Part #DAB012
OEM Part #48264

BRUSH

- 2 per package
- Size: 1/4 x 1-1/4 x 1-1/4"
- Radius: 1-1/8"
- Bevel: 5°
- Spring length: 1-5/8"
- Copper shunt wire

Fits: Brush Holder Assembly
Models: CU5000, CRU5000, DPR6000, PR-6000 & Late Model B20A

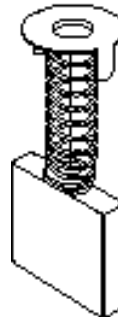

New RPI Part #IET018
Old RPI Part #DAT018
OEM Part #761

MECHANICAL TIME SWITCH

- (2 hour)**
- DPDT
 - Switch: 20A, 240VAC
 - Includes time switch, mounting hardware, and knob
- Models:** CM, CS & HT

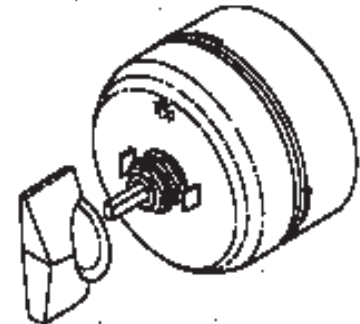

New RPI Part #IEB010
Old RPI Part #DAB010
OEM Part #1946

BRUSH

- 2 per package
- Size: 3/16 x 5/8 x 1-1/16"
- Radius: 5/8"
- Bevel: 5°
- Spring length: 1-1/8"
- Copper shunt wire

Fits: Brush Holder Assembly
Models: CS & UV



New RPI Part #IEB013
Old RPI Part #DAB013
OEM Part #47263

BRUSH

- 2 per package
- Size: 1/4 x 7/16 x 13/16"
- Radius: 1/2"
- Spring length: 1-1/8"
- Copper shunt wire
- Split brush

Fits: Brush Holder Assembly
Models: Centra-7 & 7R



New RPI Part #IEB015
Old RPI Part #DAB015
OEM Part #48192

BRUSH

- 2 per package
- Size: 3/16 x 3/8 x 1"
- Radius: 3/4"
- Spring length: 1-1/4"
- Copper shunt wire

Fits: Brush Holder Assembly
Models: Centra-7 & 7R



New RPI Part #IEB014
Old RPI Part #DAB014
OEM Part #47889

BRUSH

- 2 per package
- Size: 1/4 x 3/8 x 27/32"
- Radius: 1/2"
- Spring length: 1-1/4"
- Copper shunt wire

Fits: Brush Holder Assembly
Models: Centra-7 & 7R



RPI is the name you can trust for quality replacement parts.

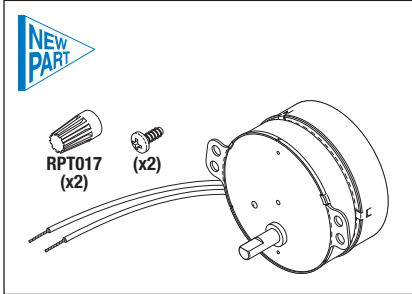

RPI Part #CAM118
OEM Part #42110601/421507/NE110

MOTOR (20 RPM, 230V)

- Bi-directional operation
- Offset shaft
- Includes all parts as shown

Fits: Motor Housing

Model: 421106 Nutator

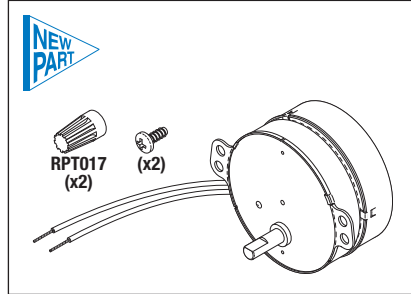

RPI Part #CAM116
OEM Part #42110501/4210504/NE100

MOTOR (24 RPM, 115V)

- Bi-directional operation
- Offset shaft
- Includes all parts as shown

Fits: Motor Housing

Models: 421105 Nutator & S0500 GyroMini

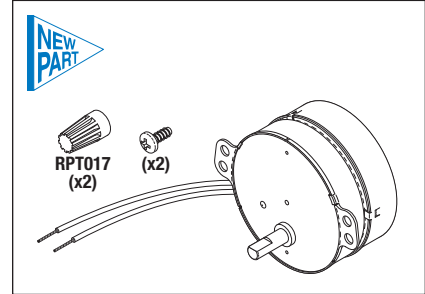

RPI Part #CAM117
OEM Part #NE111

MOTOR (18 RPM, 115V)

- Bi-directional operation
- Offset shaft
- Includes all parts as shown

Fits: Motor Housing

Model: S0600 Enduro MiniMix

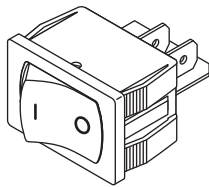

RPI Part #CAS122
OEM Part #NE210

POWER SWITCH

- Rocker switch
- 16A @ 250VAC; SPST
- .187" Tabs
- Color: Black Body with white I/O marking

Fits: Chassis

Models: S0500 GyroMini, S0600 Enduro MiniMix & H5500 Mini LabRoller

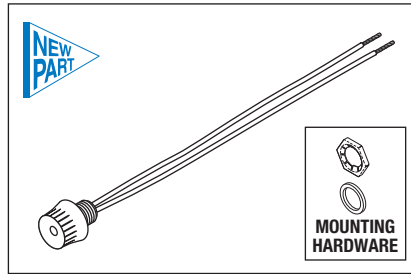

RPI Part #CAS119
OEM Part #42110502/421505

POWER SWITCH

- Rotary style: On-Off-On-Off
- 3A @ 125VAC; SPST
- Includes all parts as shown
- Wire length: ~6" lg.

Fits: Chassis

Model: 421105 Nutator

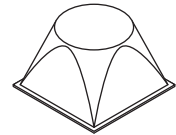

RPI Part #RPB866
OEM Part # (No OEM Part # Available)

BUMPER/FOOT

- 4 per package
- Size: .81" Square x .52" Ht.
- Material: Grey Polyurethane
- Self adhesive backing

Fits: Base

Model: 421105 Nutator

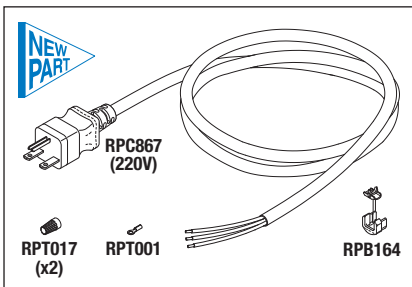

RPI Part #CAK121
OEM Part # (No OEM Part # Available)

POWER CORD KIT

- Length: ~8 ft.
- 220VAC
- Includes all parts as shown
- Also available: Strain Relief Bushing Pliers (RPI Part #RPT172)

Fits: Chassis

Model: 421106 Nutator

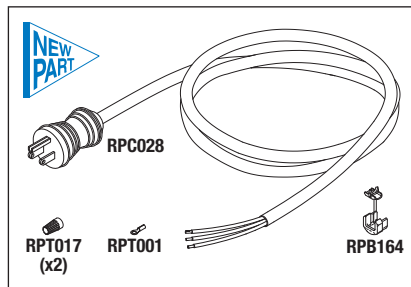

RPI Part #CAK120
OEM Part #42110503/421503

POWER CORD KIT

- Length: ~8 ft.
- 115VAC
- Includes all parts as shown
- Also available: Strain Relief Bushing Pliers (RPI Part #RPT172)

Fits: Chassis

Model: 421105 Nutator

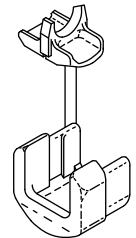

RPI Part #RPB164
OEM Part # (No OEM Part # Available)

STRAIN RELIEF BUSHING

- 8 per package
- Type: SR-6N3-4
- Cord Type: .325" - .360" round cable
- Mounting Hole: 5/8" x 1/8" THK max.
- Included in: Power Cord Kits (RPI Part #'s CAK120 & CAK121) and Strain Relief Bushing Kit (RPI Part #RPK412)
- Also available: Strain Relief Bushing Pliers (RPI Part #RPT172)

Fits: Motor Hood, Chassis

Nutators & Rotators

NOTES: _____

SECTION

3

PAGE

1101

UPDATED

05/14