

Models: Amscomatic, Eagle Series, Century V116, V120, V148 & V160 & Medallion Series



New PM Packs, Seat Kits and more to fit AMSCO/STERIS® Bulk Sterilizers!

AMSCO/STERIS®



RPI Part #AMP246
OEM Part #754360-002

PM PACK (DOOR, 16")

- Includes: Snap Action Diaphragm with Gasket (RPI Part #AMD078 & AMG101), Door Gasket (RPI Part #AMG009), Grease (RPI Part #RPG812), Spring (Lock Clutch) (RPI Part #AMS249) & (4) Cap Screws (RPI Part #AMS250)

Fits: Door Assembly

Models: All Eagle 2000 (16" x 16"), Eagle 3000 (16" x 16"), Eagle 3000 (Washer/Sterilizer), Medallion (16" x 16") and Medallion (Washer/Sterilizer)

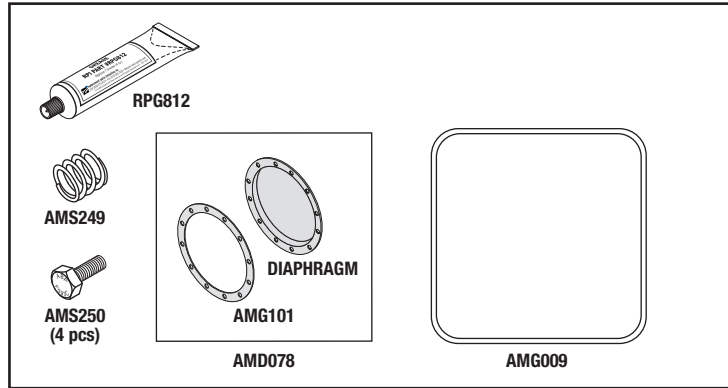

RPI Part #AMP247
OEM Part #754360-003

PM PACK (DOOR, 20")

- Includes: Snap Action Diaphragm with Gasket (RPI Part #AMD078 & AMG101), Door Gasket (RPI Part #AMG010), Grease (RPI Part #RPG812), Spring (Lock Clutch) (RPI Part #AMS249) & (4) Cap Screws (RPI Part #AMS250)

Fits: Door Assembly

Models: All Eagle 2000 (20" x 20"), Eagle 3000 (20" x 20"), Medallion (20"), and Medallion (Small - Vacumatic)

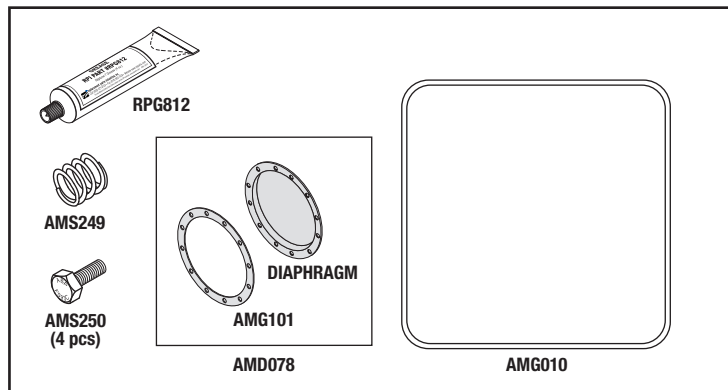

RPI Part #AMP248
OEM Part #764324-196

PM PACK (DOOR, 24" X 36")

- Includes: Snap Action Diaphragm with Gasket (RPI Part #AMD078 & AMG101), Door Gasket Kit (RPI Part #AMK056), Grease (RPI Part #RPG812), Spring (Lock Clutch) (RPI Part #AMS249) & (4) Cap Screws (RPI Part #AMS250)

Fits: Door Assembly

Models: All Eagle 2000 (Medium- Gravity), Eagle 2000 (Medium- Vacumatic), Eagle 3000 (Medium - Gravity), Eagle 3000 (Medium - Vacumatic), Medallion (Medium - Gravity) and Medallion (Medium - Vacumatic)

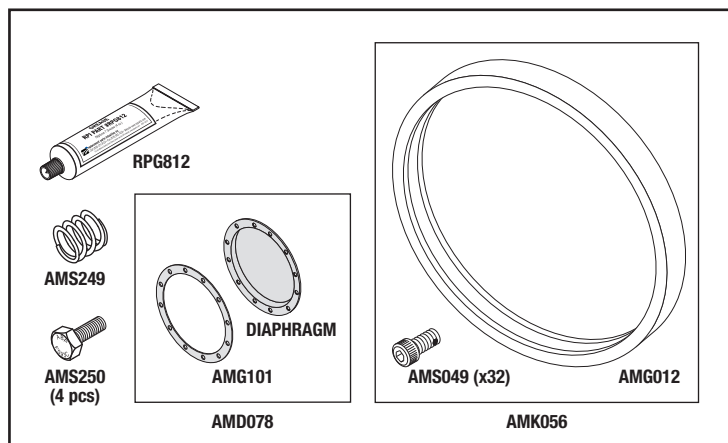

replacement parts industries, inc.

CALL (800) 221-9723 • FAX (818) 882-7028 • EMAIL order@rpiparts.com • WEBSITE www.rpiparts.com

The company, product and service names used in this document are for identification purposes only. All trademarks and registered trademarks are the property of their respective owners. Show 03/13

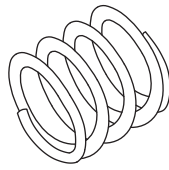

RPI Part #AMS249
OEM Part #12667-061

SPRING (LOCK CLUTCH)

- Material: Stainless steel
 - Size: .913" OD x 1.000" lg. x .092" wire diameter
 - Also included in: PM Packs (RPI Part #'s AMP246, AMP247 & AMP248)
- Fits:** Lock Clutch Assembly, Door Assembly
Models: All Eagle 2000 & 3000 Series and all Medallion Series bulk sterilizers

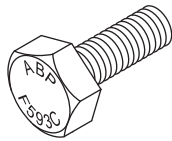

RPI Part #AMS250
OEM Part #4782-061

CAP SCREW

- 4 per package
 - 1/4-28 x 5/8" hex head cap screw
 - Material: Stainless steel
 - Head markings: F593C
 - Also included in: PM Packs (RPI Part #'s AMP246, AMP247 & AMP248)
- Fits:** Cover, Snap Action Diaphragm
Models: All Eagle 2000 & 3000 Series and all Medallion Series bulk sterilizers



RPI Part #RPG812
OEM Part #764322-635

GREASE

- Brand name: Neptune 7
 - 4 oz. tube; Color: Black
 - High Extreme Pressure properties
 - High oxidation stability
 - Water resistant
 - Also included in: PM Packs (RPI Part #'s AMP246, AMP247 & AMP248)
- Models:** All Eagle 2000 & 3000 Series and all Medallion Series bulk sterilizers



RPI Part #AMG101
OEM Part #P007753-091

DIAPHRAGM GASKET

- Also included in: Snap Action Diaphragm (RPI Part #AMD078)
- Fits:** Snap Action Diaphragm
Models: All Eagle 2000 & 3000 Series and all Medallion Series bulk sterilizers

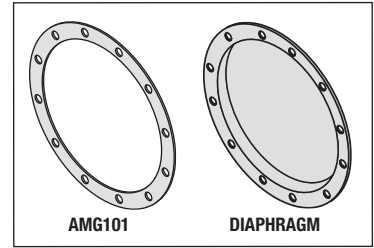

RPI Part #AMD078
OEM Part #P007230-061

SNAP ACTION DIAPHRAGM

- Includes: Diaphragm, and Diaphragm Gasket (RPI Part #AMG101)
 - Also included in: PM Packs (RPI Part #'s AMP246, AMP247 & AMP248)
- Fits:** Door Assembly
Models: All Eagle 2000 & 3000 Series and all Medallion Series bulk sterilizers



AMG012
CROSS SECTION
SHOWN ACTUAL SIZE

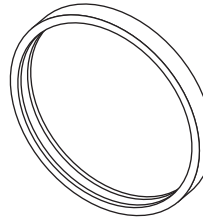

RPI Part #AMG012
OEM Part #P097487-091

DOOR GASKET

- OD: 36.00"
 - Also included in: Door Gasket Kit (RPI Part #AMK056)
- Fits:** 24" x 36" Door
Models: All Eagle 2000 (Medium- Gravity), Eagle 2000 (Medium- Vacuumatic), Eagle 3000 (Medium - Gravity), Eagle 3000 (Medium - Vacuumatic), Medallion (Medium - Gravity) and Medallion (Medium - Vacuumatic)

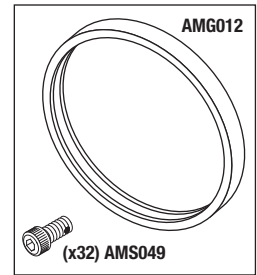

RPI Part #AMK056
OEM Part #P075006-091

DOOR GASKET KIT

- Includes: Door Gasket (RPI Part #AMG012) and (32 pcs) 1/4-28 Socket Head Cap Screw (RPI Part #AMS049)
 - Also included in: PM Pack (RPI Part #AMP248)
- Fits:** 24" x 36" Door
Models: All Eagle 2000 (Medium- Gravity), Eagle 2000 (Medium- Vacuumatic), Eagle 3000 (Medium - Gravity), Eagle 3000 (Medium - Vacuumatic), Medallion (Medium - Gravity) and Medallion (Medium - Vacuumatic)



AMG009
CROSS SECTION
SHOWN ACTUAL SIZE

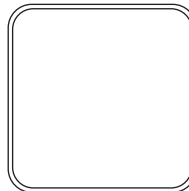

RPI Part #AMG009
OEM Part #P074367-091

DOOR GASKET

- OD: 19.80"
 - C/S: .375" Sq.
 - Also included in: PM Pack (RPI Part #AMP246)
- Fits:** 16" x 16" Square Door
Models: All Eagle 2000 (16" x 16"), Eagle 3000 (16" x 16"), Eagle 3000 (Washer/Sterilizer), Medallion (16" x 16") and Medallion (Washer/Sterilizer)



AMG010
CROSS SECTION
SHOWN ACTUAL SIZE

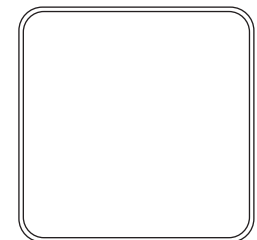

RPI Part #AMG010
OEM Part #P078767-091

DOOR GASKET

- OD: 24.53"
 - C/S: .375" Sq.
 - Also included in: PM Pack (RPI Part #AMP247)
- Fits:** 20" x 20" Square Door
Models: All Eagle 2000 (20" x 20"), Eagle 3000 (20" x 20"), Medallion (20"), and Medallion (Small - Vacuumatic)



RPI Part #AMV263
OEM Part #150828-476

SAFETY VALVE (40 PSI)

- 3/4" MPT x 1" FPT
- Material: Bronze body; Viton seal
- Cracking pressure: 40 PSI

Fits: Chamber Jacket

Models: Eagle 2000 (16" Gravity Stage II), Eagle 2000 (16" Vacumatic Stage II), Eagle 2000 (20" Gravity Stage II), Eagle 2000 (20" Vacumatic Stage II), Eagle 2000 (Medium - Gravity Stage II), Eagle 2000 (Medium - Vacumatic Stage II), Eagle 3000 (16" Gravity Stage II), Eagle 3000 (16" Vacumatic Stage II), Eagle 3000 (20" Gravity Stage II), Eagle 3000 (20" Vacumatic Stage II), Eagle 3000 (Medium - Gravity Stage II) & Eagle 3000 (Medium - Vacumatic Stage II)

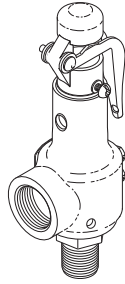

RPI Part #CSV086
OEM Part #150828-478

SAFETY VALVE (40 PSI)

- 1" MPT x 1-1/4" FPT
- Material: Bronze body; EPDM seal
- Cracking pressure: 40 PSI

Fits: Chamber Jacket

Models: Eagle 3000 (16" Gravity Stage III), Eagle 3000 (16" Vacumatic Stage III), Eagle 3000 (20" Gravity Stage III), Eagle 3000 (20" Vacumatic Stage III), Eagle 3000 (Medium - Gravity Stage III) & Eagle 3000 (Medium - Vacumatic Stage III)

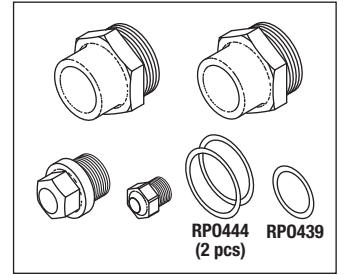
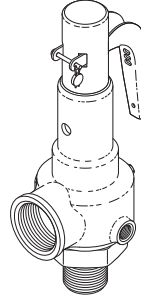

RPO444
(2 pcs)

RPI Part #AMK215
OEM Part #764326-476

SEAT KIT (STEAM)

- Material: Stainless steel seats & Viton o-rings
- Includes: .218" seat, .375" seat, (2) .625" seats, O-ring (RPI Part #RPO439) & (2 pcs) O-ring (RPI Part #RPO444)

Fits: Steam Manifold

Models: Century V116 & V120

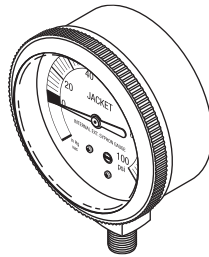

RPI Part #AMG244
OEM Part #7871-051

PRESSURE GAUGE (JACKET)

- 2.5" Dial
- Scale: 30 in. Hg Vac to 0 PSI (unmarked) and 0-100 PSI (marked)
- Dial face: White with black characters
- 1/8" MPT bottom mount
- Zero adjustment

Fits: Jacket

Models: Century V116 & V120

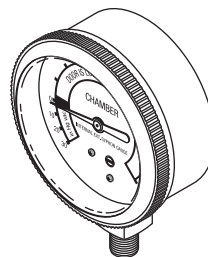

RPI Part #AMG245
OEM Part #7872-051

PRESSURE GAUGE (CHAMBER)

- 2.5" Dial
- Scale: 30 in. Hg Vac to 0 PSI (marked) and 0-100 PSI (unmarked)
- Dial face: White with black characters
- 1/8" MPT bottom mount
- Zero adjustment

Fits: Chamber

Models: Century V116 & V120

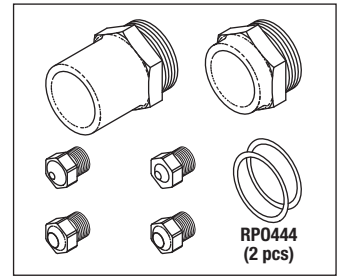

RPO444
(2 pcs)

RPI Part #AMK216
OEM Part #764326-481

SEAT KIT (EXHAUST)

- Material: Stainless steel seats and Viton o-rings
- Includes: .094" seat, .109" seat, .750" short seat, .750" long seat, (2) .218" seats & (2 pcs) O-ring (RPI Part #RPO444)

Fits: Exhaust Manifold

Models: Century V116 & V120



AMG207
CROSS SECTION
SHOWN ACTUAL SIZE

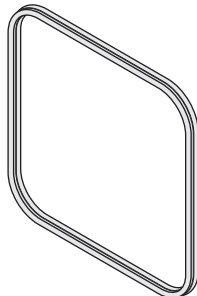

RPI Part #AMG207
OEM Part #146660-159

DOOR GASKET (16" x 16")

- Size: 16" x 16"
- **Fits:** Chamber Assembly
- **Models:** Century V116



AMG208
CROSS SECTION
SHOWN ACTUAL SIZE

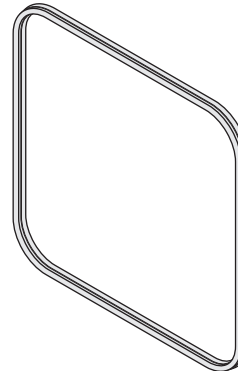

RPI Part #AMG208
OEM Part #146660-160

DOOR GASKET (20" x 20")

- Size: 20" x 20"
- **Fits:** Chamber Assembly
- **Models:** Century V120

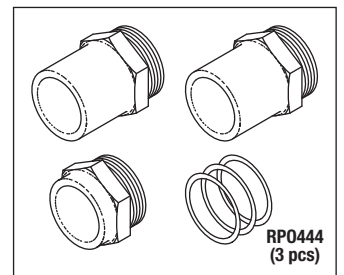

RPO444
(3 pcs)

RPI Part #AMK217
OEM Part #764326-620

SEAT KIT (WATER)

- Material: Stainless steel seats & Viton o-rings
- Includes: .750" short seat, (2) .750" long seats & (3 pcs) O-ring (RPI Part #RPO444)

Fits: Water Manifold

Models: Century V116 & V120



replacement parts industries, inc.

20338 Corisco Street • Chatsworth, California • 91311

PRESORTED STANDARD
U.S. POSTAGE PAID
VAN NUYS, CA
PERMIT NO. 2399

ADDRESS SERVICES REQUESTED

LOOK!

**New Parts to fit
AMSCO/STERIS®
Bulk Sterilizers**

Including:

- **PM Packs**
- **Seat Kit (Steam)**
- **Seat Kit (Exhaust)**
- **Seat Kit (Water)**
- **Grease**
- **Spring (Lock Clutch)**
- **Cap Screw**



replacement parts industries, inc.

"The Alternate Source"®

"Serving the Healthcare Industry since 1972. RPI is proud to be an ISO 9001 Certified Company."

Pay an Invoice

CART

QUICK SEARCH

PART SEARCH

TECH SUPPORT

CUSTOMER SUPPORT

RPI NEWS!

PLACE AN ORDER

Login

PART SEARCH BY
EQUIPMENT TYPE

ASPIRATORS &
SUCTION PUMPS

AUTOCLAVES

AUTOPSY SAWS

BULK STERILIZERS &
ENDOSCOPE WASHERS

CAST CUTTERS &
SPREADERS

CENTRIFUGES

DENTAL
EQUIPMENT

ECG/EKG & EEG

EXAM TABLES &
CHAIRS

**RPI Is Your Best Source For Parts To Fit
AMSCO/STERIS® Bulk Sterilizers!**

Go to www.rpiparts.com for a complete list of parts to fit
AMSCO/STERIS® Amscomatic, Century, Eagle and Medallion Series
bulk sterilizers including:

- Bellows
- Bonnet & Sylphon Assemblies
- Door Gaskets
- Pressure Gauges
- PRV Kits
- Safety Valves
- Solenoid Valve Repair Kits
- Steam Trap Assemblies
- Steam Trap Repair Kits
- and more!